

FITONNTM
ARCHITECTURAL HARDWARE



Product Catalogue



Company Profile

Fitonn Architectural Hardware Quality products are always up to date and make big efforts to deliver the right quality at the right time. We are located in the heart of Delhi with skilled worker to produce the most reliable product and efficient delivery.

We understand that buyers are value-conscious. Thus we operate efficiently, to maintain the lowest overhead, and ensure competitive price.

We emphasize on providing the best quality products to our customers that can be assured through our infinite quality control efforts. To satisfy our clientele, we always emphasize on the quality of the products hence subject the manufactured products to stringent quality checks. Quality raw materials make the product range the foremost choice in the market.

Further more there attributes of our ethical business policy quality product, timely delivery and competitive price have helped us in forming in clientele.

CONTENTS

01	Floor Spring	30	Door Closer
04	Hydraulic Patch Fitting	31	Locks Without Cutout
06	Patch Fittings	34	Door Handles with Locks
09	Shower Hinges	35	Door Handles
11	Glass Connectors	38	Automatic Sensor Doors
12	Plastic Profiles	39	Shelf Support Buttons & Brackets
13	Shower Knight Head Accessories	40	Mirror Accessories
14	Door Knobs	41	Bracket Shelf Holder
15	Shower Sliding System	41	Glass Hinges with Hole
16	Office Sliding System	41	Glass Hinges without Hole
18	Sliding Folding System	42	Other Hardware Product
19	Frameless Sliding Folding System	42	Glass Runner / Glass Lifter / Screws & Bolts
20	Sliding Door System	43	Glass Railing Accessories
21	Manet Sliding System	46	Washroom Partitions
22	Sliding Folding System	47	Double Sided Structural Glazing Tape
23	Canopy Fittings	47	Adhesive
23	Point Fixed Fittings	48	Silicon Sealant
24	Spider Fittings	48	Silicone Gun
28	Articulated Routels		
29	Fin Plates & Splice Plates		



AN ISO 9001: 2015 Certified Company



Water Resistant Seal
Inside of Cover Plate



FOFS-74A FOFS-84A FLOOR HINGE

FLOOR SPRING



FOFS-6600
Single Spring Floor Hinge
₹ 2700.00

Specification

- ▲ General design, suitable for left or right hand to open the door in single and both sides.
- ▲ Used low temp. hydraulic oil for any climate operation and constant lubrication.
- ▲ Suitable for wooden and toughened glass doors.
- ▲ Suitable for door weight from 55kgs.
- ▲ Closing force 19nm.
- ▲ Suitable for maximum wide door leaf (900x2100mm).
- ▲ Tested to 600000 Cycles.
- ▲ Opening angle 90° / 115°
- ▲ 304 SS Plate

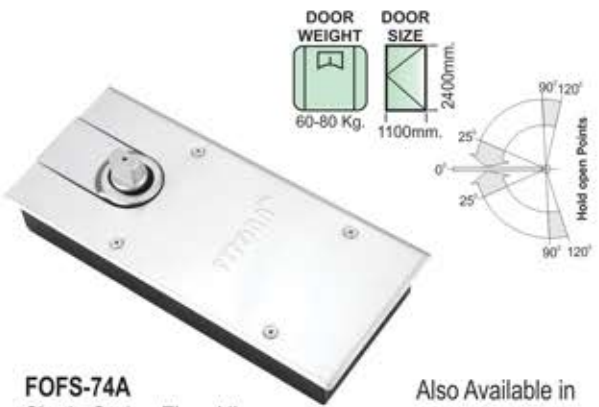
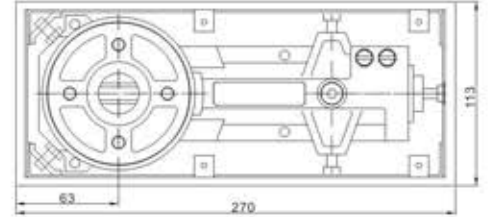

FOFS-74A
Single Spring Floor Hinge
₹ 2960.00

Also Available in
Rose Gold | Gold | Black

Specification

- ▲ General design, suitable for left or right hand to open the door in single and both sides.
- ▲ Used low temp. hydraulic oil for any climate operation and constant lubrication.
- ▲ Suitable for wooden and toughened glass doors.
- ▲ Suitable for door weight from 60-80kgs.
- ▲ Closing force 25nm.
- ▲ Suitable for maximum wide door leaf (1100x2400mm).
- ▲ Tested to 600000 Cycles.
- ▲ Opening angle 90° / 115°
- ▲ 304 SS Plate

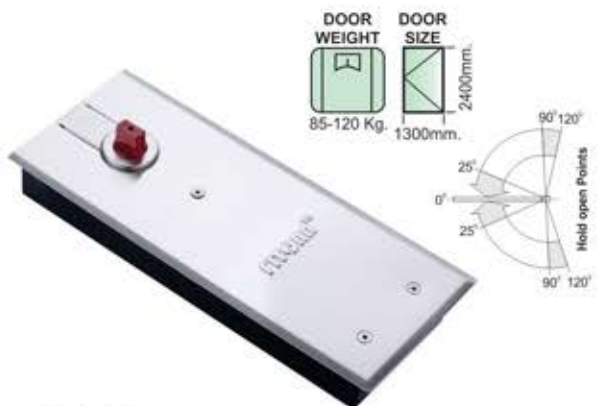
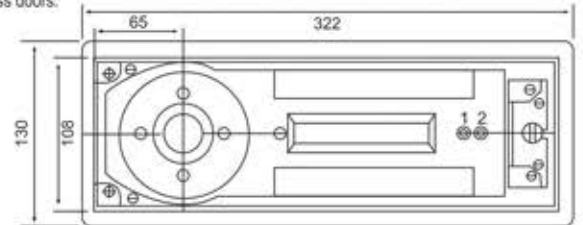

FOFS-84 A
Double Spring Floor Hinge
₹ 4245.00

Also Available in
Rose Gold | Gold | Black



TESTED TO
1000000
CYCLES

Specification

- ▲ General design, suitable for left or right hand to open the door in single and both sides.
- ▲ Used low temp. hydraulic oil for any climate operation and constant lubrication.
- ▲ Suitable for wooden and toughened glass doors.
- ▲ Suitable for door weight from 85-120kgs.
- ▲ Closing force 25nm.
- ▲ Suitable for maximum wide door leaf (1300x2400mm).
- ▲ Opening angle 90° / 115°
- ▲ 304 SS Plate

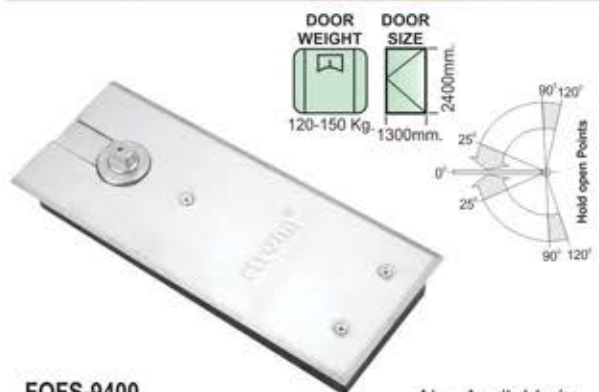
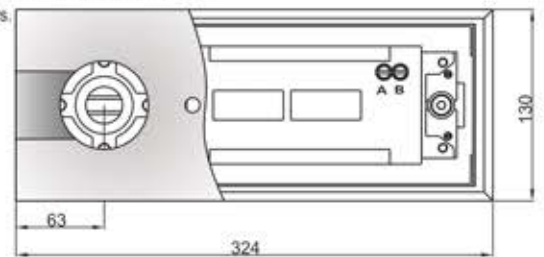

FOFS-9400
Double Spring Floor Hinge
₹ 5530.00

Also Available in
Rose Gold | Gold | Black

Specification

- ▲ General design, suitable for left or right hand to open the door in single and both sides.
- ▲ Used low temp. hydraulic oil for any climate operation and constant lubrication.
- ▲ Suitable for wooden and toughened glass doors.
- ▲ Suitable for door weight from 120-150kgs.
- ▲ Closing force 25nm.
- ▲ Suitable for maximum wide door leaf (1300x2400mm).
- ▲ Tested to 600000 Cycles.
- ▲ Opening angle 90° / 115°
- ▲ 304 SS Plate

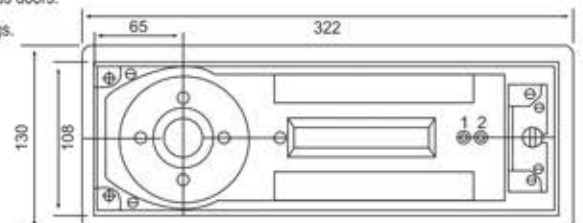

FLOOR SPRING

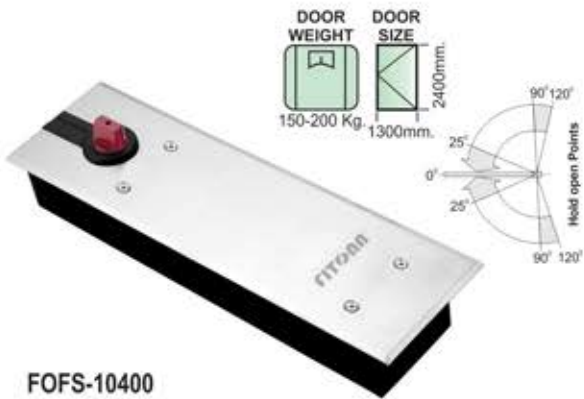

DOOR WEIGHT
150-200 Kg.
DOOR SIZE
1300mm.
2400mm.

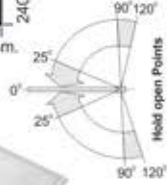

Specification

- ▲ General design, suitable for left or right hand to open the door in single and both sides.
- ▲ Used low temp. hydraulic oil for any climate operation and constant lubrication.
- ▲ Suitable for wooden and toughened glass doors.
- ▲ Suitable for door weight from 150-200kgs.
- ▲ Closing force 25nm.
- ▲ Suitable for maximum wide door leaf (1300x2400mm).
- ▲ Tested to 600000 Cycles.
- ▲ Opening angle 90° / 115°
- ▲ 304 SS Plate

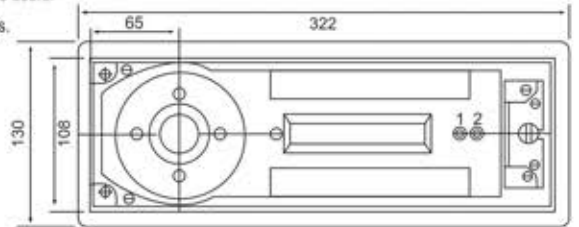

FOFS-10400
Double Spring Floor Hinge
₹ 8100.00



Combo Set FOFS-74 A ₹ 6430.00



Combo Set FOFS-84 A ₹ 7725.00



HYDRAULIC PATCH

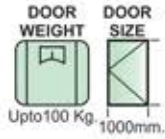

Taiwan production line



FOHPP-100
Hydraulic Floor Spring
₹ 6435.00

Specification

- ▲ Suitable door weight : Max 100kg
- ▲ Suitable door width : 1050mm
- ▲ Suitable door thickness : 8~13mm
- ▲ Ambient temperature : -20°C~+50°C
- ▲ Quick and easy installation

Max. opening angle: 150° for left and right opening (double action)
Hold open at 90°

Two speed adjustment
Closing Speed (150° ~ 10°)
Braking speed (10° ~ 0°)

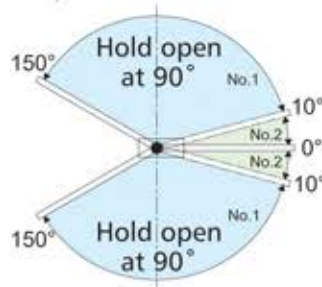
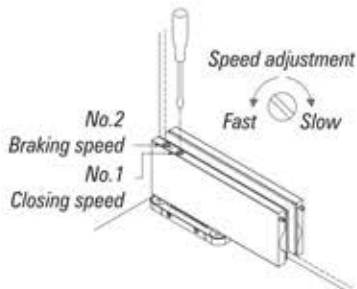

DFHPP-100 Combo Set ₹ 9150.00

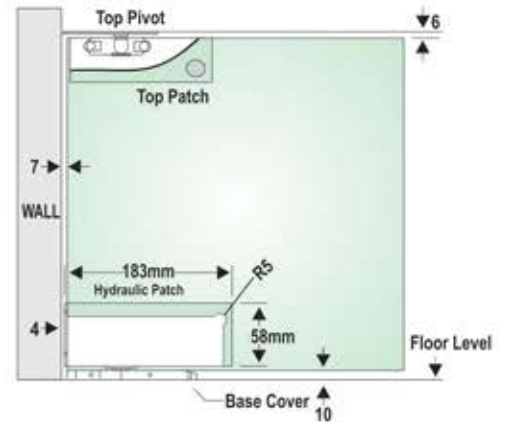

PATCH FITTINGS



Specification

- Finish : Satin stainless steel
- Pivot point of 55 / 65mm
- With **SS 304** cover of 1 mm thickness
- High quality tempered precision screws are used to ensure solid gripping



FOPF-10
Top Patch
₹ 700.00

Also Available in
Rose Gold Gold Black

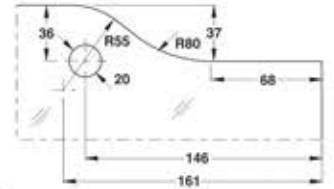

Specification

- Finish : Satin stainless steel
- Suitable for Kliff Floor Hinge or any other reputed manufacturer
- Pivot point of 55 / 65mm
- With **SS 304** cover of 1 mm thickness
- High quality tempered precision screws are used to ensure solid gripping



FOPF-20
Bottom Patch
₹ 700.00

Also Available in
Rose Gold Gold Black

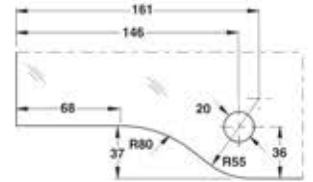

Specification

- Finish : Satin stainless steel
- Suitable to secure over panel with the wall by pivot pin of 15mm dia
- Pivot point of 55/65mm
- With **SS 304** cover of 1 mm thickness
- High quality tempered precision screws are used to ensure solid gripping



FOPF-50
Wall Mounted Over Panel
Patch with Pivot (Over Panel)
₹ 735.00

Also Available in
Rose Gold Gold Black

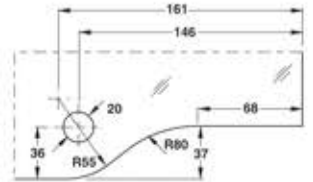

Patch fittings made of superior aluminum alloy casting body. Material used is of very fine quality which minimizes the chances of breakage and also enhances the gripping of glass to patch. High quality tempered precision screws are used for solid gripping. Cover plate is of high quality SS 304 grade.



PATCH FITTINGS



FOPF-40
Over Panel Side Panel Connecting Patch
with Pivot (Big L)
₹ 965.00

Also Available in
Rose Gold Gold Black

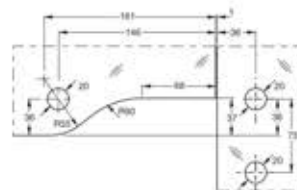

Specification

- Finish : Satin stainless steel
- Suitable for connecting over panel & side panel
- Pivot point of 55 / 65mm
- With **SS 304** cover of 1 mm thickness
- High quality tempered precision screws are used to ensure solid gripping



FOPL-90
Corner Patch Lock with Strike Plate
₹ 1225.00

Also Available in
Rose Gold Gold Black

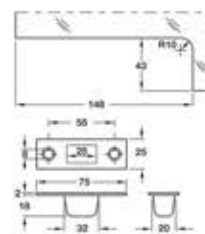

Specification

- Finish : Satin stainless steel Suitable to lock swing doors.
- With a euro profile cylinder and strike plate
- With 3 high Security computerized keys
- Single Throw Rectangular Bolt with 15mm Projection
- With **SS 304** cover of 1 mm thickness
- High quality tempered precision screws are used to ensure solid gripping



FOPF-610
Over Panel Side Panel Patch Connector
(Small L)
₹ 700.00

Also Available in
Rose Gold Gold Black

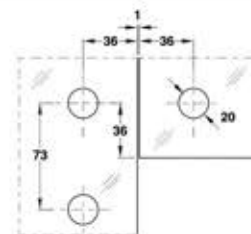

Specification

- Finish : Satin stainless steel
- Suitable for fixing over panel & side panel at the opening top corner of the door.
- Corner small L Patch
- With **SS 304** cover of 1 mm thickness
- High quality tempered precision screws are used to ensure solid gripping



FOPL-2A
Centre Patch Lock
₹ 1225.00

Also Available in
Rose Gold Gold Black



Specification

- Finish : Satin stainless steel Suitable to Lock swing doors.
- Can also be use to lock doors from center.
- With a euro profile cylinder and strike plate
- with 3 high Security computerized keys
- Single Throw Rectangular Bolt with 15mm Projection
- With **SS 304** cover of 1 mm thickness
- High quality tempered precision screws are used to ensure solid gripping



FOPL-2B
Centre Lock Strike Box
₹ 900.00

Also Available in
Rose Gold Gold Black

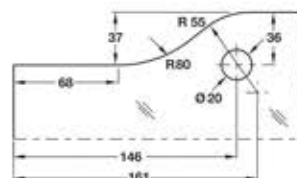

Specification

- Finish : Satin stainless steel
- Suitable to Lock double doors.
- strike box for **KPL-2 A**
- With **SS 304** cover of 1 mm thickness
- High quality tempered precision screws are used to ensure solid gripping



FOPL-3A
Latch Lock
₹ 1155.00

Also Available in
Rose Gold Gold Black



Specification

- Finish : Satin stainless steel (SSS)
- Suitable to lock swing sliding & sliding doors.
- Can also be use to lock the door from center/top
- Thumb turn lock with single throw
- With **SS 304** cover of 1 mm thickness
- High quality tempered precision screws are used to ensure solid gripping



FOPL-3B
Strike Box
₹ 735.00

Also Available in
Rose Gold Gold Black

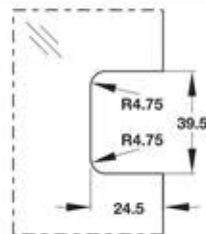

Specification

- Finish : Satin stainless steel
- Suitable for fixing glass with ceiling, floor & wall
- For fixing with fixed structure
- With **SS 304** cover of 1 mm thickness
- High quality tempered precision screws are used to ensure solid gripping

PATCH FITTINGS

Specification

- Finish : Satin stainless steel
- Suitable for fixing over panel & side panel along with fin
- Over panel side panel with fin inside
- With **SS 304** cover of 1 mm thickness
- High quality tempered precision screws are used to ensure solid gripping



FOPF-41R
Over Panel Side Panel Connector with Fin (Right)
₹ 4140.00

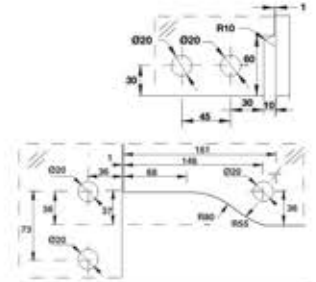

Specification

- Finish : Satin stainless steel
- Suitable for fixing over panel & side panel along with fin
- Over panel side panel with fin inside
- With **SS 304** cover of 1 mm thickness
- High quality tempered precision screws are used to ensure solid gripping



FOPF-41L
Over Panel Side Panel Connector with Fin (Left)
₹ 4140.00

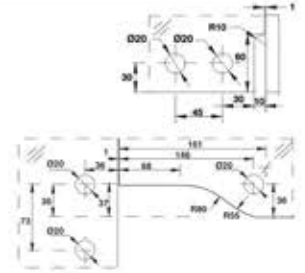

Specification

- Finish : Satin stainless steel
- Suitable for fixing over panel & side along with fin to be used at the opening top corner of the door.
- L / R shape from outside with fin inside
- With **SS 304** cover of 1 mm thickness
- High quality tempered precision screws are used to ensure solid gripping



FOPF-610L/R
Triple Glass Patch Connector with Fin (Left/Right)
₹ 2700.00

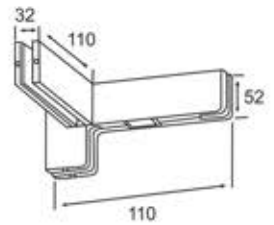

Specification

- Finish : Satin stainless steel
- Suitable for fixing glass with ceiling & wall
- For fixing with fixed structure
- With **SS 304** cover of 1 mm thickness
- High quality tempered precision screws are used to ensure solid gripping



FOPF-640A
Wall to Glass Connecting Patch
₹ 615.00



FOPF-640
Wall to Glass Connecting Patch
₹ 250.00

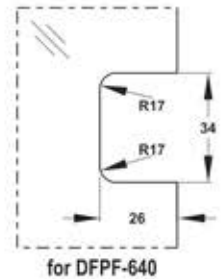

Specification

- Finish : Satin stainless steel
- Suitable for fixing two glass together with ceiling, floor & wall
- With **SS 304** cover of 1 mm thickness
- High quality tempered precision screws are used to ensure solid gripping



FOPF-650
Glass to Glass Connecting Patch with Wall/Ceiling
₹ 465.00

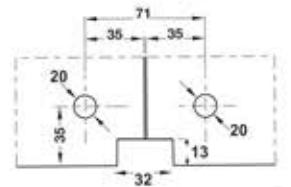

Specification

- Finish : Satin stainless steel
- Suitable for back to back doors with pivot along with fin
- Over panel with pivot for back to back doors
- With **SS 304** cover of 1 mm thickness
- High quality tempered precision screws are used to ensure solid gripping



FOPF-51
Double Over Panel Patch with Fin
₹ 4140.00

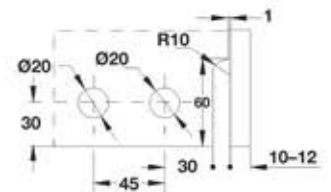

Specification

- Finish : Satin stainless steel
- Suitable for fixing over panel & side along with fin to be used at the opening top corner of the door.
- L shape from outside with fin inside
- With **SS 304** cover of 1 mm thickness
- High quality tempered precision screws are used to ensure solid gripping



FOPF-51 D
Double Over Panel Patch
₹ 3600.00

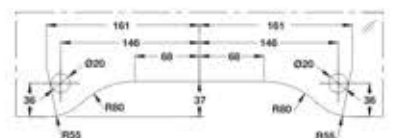

PATCH FITTINGS



Specification

- Finish : Satin stainless steel
- Suitable for fixing over panel & side panel at the opening top corner of the door also restricts one side opening of the door
- Square look from one side & L shape from another side
- With **SS 304** cover of 1 mm thickness
- Cover fixed with Allen screw to ensure that the cover remained secure in its place

FOPL-610ST
Over Panel Side Panel Patch Connector with Stopper
₹ 1225.00

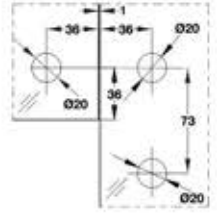

Specification

- Finish : Satin stainless steel
- Suitable for fixing maximum four no's of fixed glass
- For fixing maximum up to four glasses
- With **SS 304** cover of 1 mm thickness
- High quality tempered precision screws are used to ensure solid gripping

FOPF-620
Quadruple Patch
₹ 1675.00

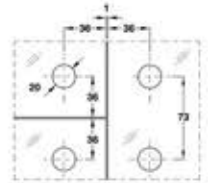

Specification

- Finish : Satin stainless steel
- Suitable for fixing maximum four fixed glasses with fin inside.
- For fixing maximum four glasses in line with fin inside
- With **SS 304** cover of 1 mm thickness
- High quality tempered precision screws are used to ensure solid gripping

FOPF-620F
Quadruple Patch with Fin
₹ 4000.00

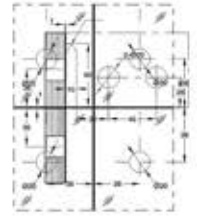

Specification

- Finish : Satin stainless steel
- Suitable for fixing two fixed glasses in line with fin inside.
- For fixing two glasses in line with fin inside
- With **SS 304** cover of 1 mm thickness
- High quality tempered precision screws are used to ensure solid gripping

FOPF-650F
Connector with Fin
₹ 3600.00

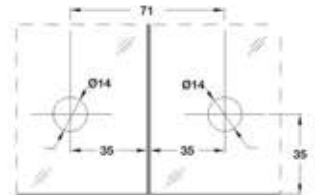

Specification

- Finish : Satin stainless steel
- Suitable for fixing two fixed glasses.
- For fixing two glasses in line
- With **SS 304** cover of 1 mm thickness
- High quality tempered precision screws are used to ensure solid gripping

FOPF-660
Double Glass Connecting Patch
₹ 585.00

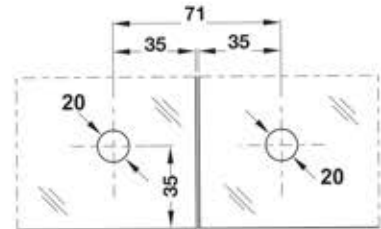

FOFS-ACC-GDP
Top Pivot for Patch Fittings Doors
₹ 115.00



FOFS-ACC-TP/BP
Top Pivot/Bottom Pivot
for Wooden/Aluminium Doors
₹ 255.00



FOFS-MFH
Mini Floor Hinge
₹ 835.00



FOGDS
Glass Door Stopper
₹ 115.00

SHOWERHINGES

FOSH-1 H/P
Wall to Glass 90° Off Set Hinge
Material : SS 304
Door Thickness : 8mm-12mm
Weight Cap. : 45kg
Finish : Matt & Chrome Plated
₹ 1260.00

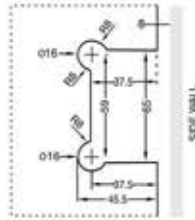

Edge Series

Edge Series Also Available in
Rose Gold | Gold | Black

FOSH-11 H/P
Wall to Glass 90° Off Set Hinge
Material : SS 304 / ED
Door Thickness : 8mm-12mm
Weight Cap. : 45kg
Finish : Matt & Chrome Plated
₹ 1135.00

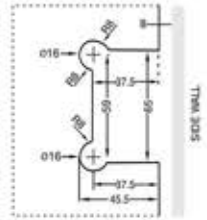

FOSH-1
Wall to Glass 90° Hinge
Material : SS 304
Door Thickness : 8mm-12mm
Weight Cap. : 45kg
Finish : Matt & Chrome Plated
₹ 1260.00

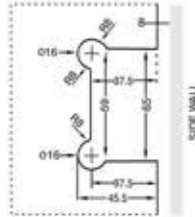

FOSH-11
Wall to Glass 90° Hinge
Material : SS 304 / ED
Door Thickness : 8mm-12mm
Weight Cap. : 45kg
Finish : Matt & Chrome Plated
₹ 1135.00

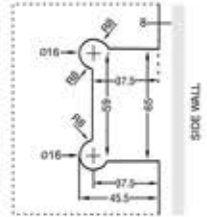

FOSH-2
Glass to Glass 180° Hinge
Material : SS 304
Door Thickness : 8mm-12mm
Weight Cap. : 45kg
Finish : Matt & Chrome Plated
₹ 1775.00

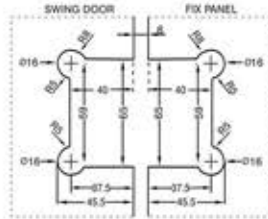

FOSH-22
Glass to Glass 180° Hinge
Material : SS 304 / ED
Door Thickness : 8mm-12mm
Weight Cap. : 45kg
Finish : Matt & Chrome Plated
₹ 1650.00

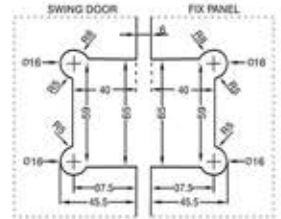

FOSH-3
Glass to Glass 135° Hinge
Material : SS 304
Door Thickness : 8mm-12mm
Weight Cap. : 45kg
Finish : Matt & Chrome Plated
₹ 1775.00

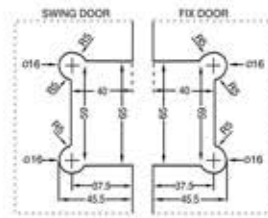

FOSH-33
Glass to Glass 135° Hinge
Material : SS 304 / ED
Door Thickness : 8mm-12mm
Weight Cap. : 45kg
Finish : Matt & Chrome Plated
₹ 1650.00

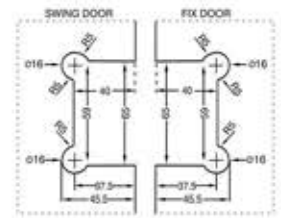

FOSH-4
Glass to Glass 90° Hinge
Material : SS 304
Door Thickness : 8mm-12mm
Weight Cap. : 45kg
Finish : Matt & Chrome Plated
₹ 1990.00

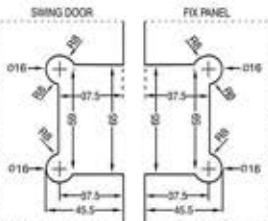

FOSH-44
Glass to Glass 90° Hinge
Material : SS 304 / ED
Door Thickness : 8mm-12mm
Weight Cap. : 45kg
Finish : Matt & Chrome Plated
₹ 1775.00

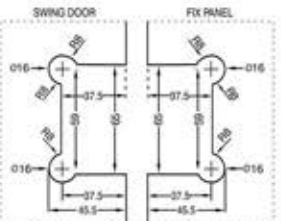

FOSH-5
Wall to Glass 90° Fix Bracket
Material : SS 304
Door Thickness : 8mm-12mm
Weight Cap. : 45kg
Finish : Matt & Chrome Plated
₹ 1150.00

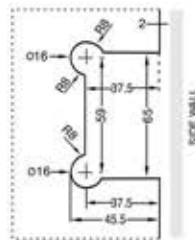

FOSH-55
Wall to Glass 90° Fix Bracket
Material : SS 304 / ED
Door Thickness : 8mm-12mm
Weight Cap. : 45kg
Finish : Matt & Chrome Plated
₹ 1030.00

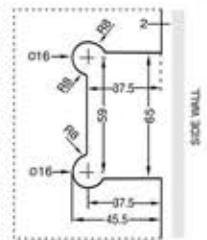

FOSH-6
Double Glass Hinge Joint with Fixed Glass
Specification
Self closing function for both doors when stays at 30° approx.
Material : SS 304
Door Thickness : 8mm-12mm
Weight Capacity : 45kg
Finish : Satin Nikle & Chrome Plated
With Gasket to Prevent Glass From Damage
Secure Holding with Glass
₹ 4630.00

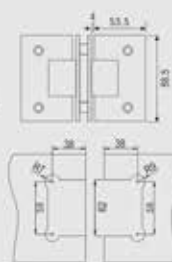

FOSH-7
Pivot Hinge for Floor/Ceiling
Specification
Material : SS 304
Door Thickness : 8mm-12mm
Weight Capacity : 45kg
Finish : Matt & Chrome Plated
With Gasket to Prevent Glass From Damage
Secure Holding with Glass
₹ 4630.00

SHOWER HINGES

FOSH-111 H/P
 Wall to Glass 90° Off Set Hinge
Material : Forged Brass
 Door Thickness : 8mm-12mm
 Weight Cap. : 45kg
 Finish : Matt & Chrome Plated
 ₹ 1685.00

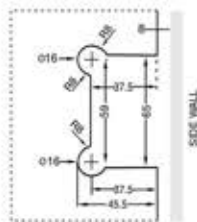

FOSH-111
 Wall to Glass 90° Hinge
Material : Forged Brass
 Door Thickness : 8mm-12mm
 Weight Cap. : 45kg
 Finish : Matt & Chrome Plated
 ₹ 1685.00

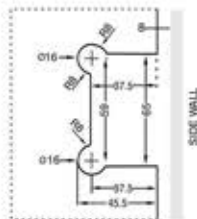

FOSH-222
 Glass to Glass 180° Hinge
Material : Forged Brass
 Door Thickness : 8mm-12mm
 Weight Cap. : 45kg
 Finish : Matt & Chrome Plated
 ₹ 2700.00

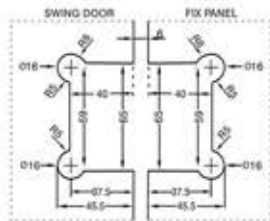

FOSH-333
 Glass to Glass 135° Hinge
Material : Forged Brass
 Door Thickness : 8mm-12mm
 Weight Cap. : 45kg
 Finish : Matt & Chrome Plated
 ₹ 2700.00

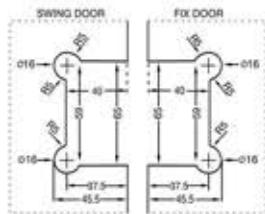

FOSH-4
 Glass to Glass 90° Hinge
Material : Forged Brass
 Door Thickness : 8mm-12mm
 Weight Cap. : 45kg
 Finish : Matt & Chrome Plated
 ₹ 2835.00

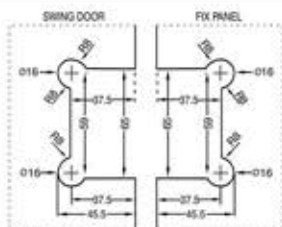

FOSH-5
 Wall to Glass 90° Fix Bracket
Material : Forged Brass
 Door Thickness : 8mm-12mm
 Weight Cap. : 45kg
 Finish : Matt & Chrome Plated
 ₹ 1545.00

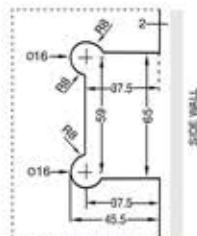
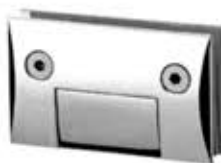

Hydraulic Shower Hinges

NEW

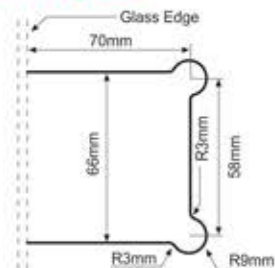

FOSH-01 H
 Wall to Glass Hinge

Specification
Material : SS 304
 Glass Thickness : 8mm-12mm
 Weight Cap. : 45kg
 Finish : Matt & Chrome Plated
 With Gasket to Prevent Glass From Damage
 Secure Holding with Glass
 ₹ 5400.00

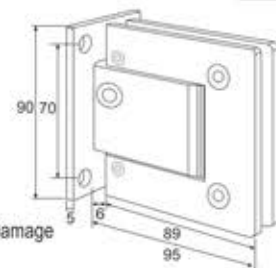

NEW

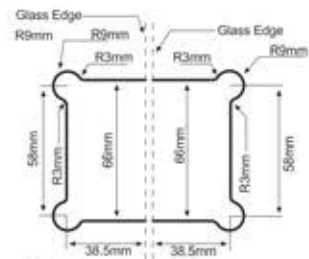

FOSH-02 H
 Glass to Glass Hinge

Specification
Material : SS 304
 Glass Thickness : 8mm-12mm
 Weight Cap. : 45kg
 Finish : Matt & Chrome Plated
 With Gasket to Prevent Glass
 From Damage Secure Holding with Glass
 ₹ 6430.00

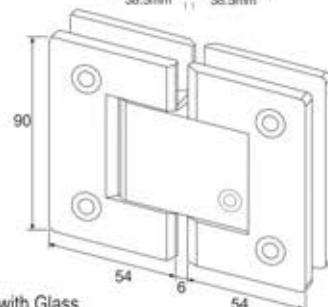

GLASS CONNECTORS

NEW!



FOGC-1
U Connector
Material : WM / Brass
Door Thickness : 8mm-12mm
Finish : Matt & Chrome Plated
₹ 285.00

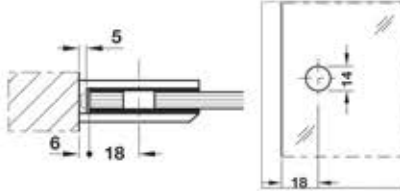

FOGC-11
U Connector
Material : SS 304
Door Thickness : 8mm-12mm
Finish : Matt & Chrome Plated
₹ 150.00 (3mm)
₹ 170.00 (4mm)



FOGC-2
Glass to Glass 135°
Material : WM / Brass
Door Thickness : 8mm-12mm
Finish : Matt & Chrome Plated
₹ 465.00

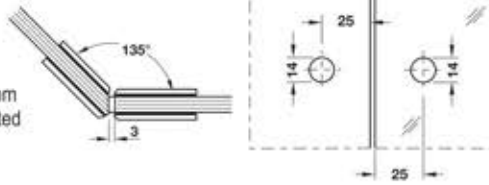

FOGC-22
Glass to Glass 135°
Material : SS 304
Door Thickness : 8mm-12mm
Finish : Matt & Chrome Plated
₹ 220.00 (3mm)
₹ 250.00 (4mm)



FOGC-3
Glass to Glass 90°
Material : WM / Brass
Door Thickness : 8mm-12mm
Finish : Matt & Chrome Plated
₹ 465.00

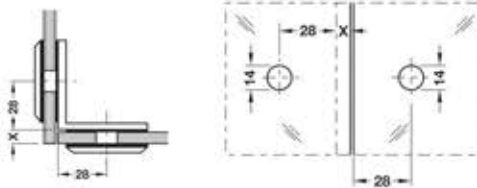

FOGC-33
Glass to Glass 90°
Material : SS 304
Door Thickness : 8mm-12mm
Finish : Matt & Chrome Plated
₹ 220.00 (3mm)
₹ 250.00 (4mm)



FOGC-4
L Connector
Material : WM / Brass
Door Thickness : 8mm-12mm
Finish : Matt & Chrome Plated
₹ 310.00

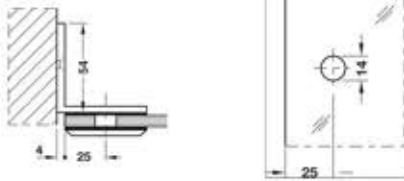

FOGC-44
L Connector
Material : SS 304
Door Thickness : 8mm-12mm
Finish : Matt & Chrome Plated
₹ 155.00 (3mm)
₹ 180.00 (4mm)



FOGC-5
Glass to Glass 180°
Material : WM / Brass
Door Thickness : 8mm-12mm
Finish : Matt & Chrome Plated
₹ 465.00

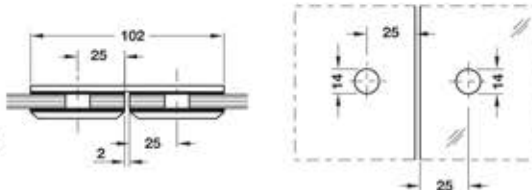

FOGC-55
Glass to Glass 180°
Material : SS 304
Door Thickness : 8mm-12mm
Finish : Matt & Chrome Plated
₹ 220.00 (3mm)
₹ 250.00 (4mm)

NEW



FOGC-111
U Connector
₹ 160.00



FOGC-222
Glass to Glass 135°
₹ 250.00



FOGC-333
Glass to Glass 90°
₹ 250.00



FOGC-444
L Connector
₹ 165.00



FOGC-555
Glass to Glass 180°
₹ 250.00



FOGC-66
T-Connector Glass to Glass 90°
Material : SS 304
Door Thickness : 8mm-12mm
Finish : Matt & Chrome Plated
Suitable for holding 3 glasses together
₹ 600.00

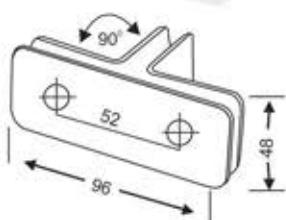

PLASTIC PROFILES

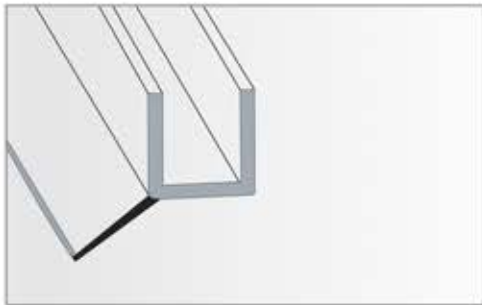

FOGP-1
8mm (2.2mtr.) ₹ 105.00 8mm (2.5mtr.) ₹ 115.00
10mm (2.2mtr.) ₹ 105.00 10mm (2.5mtr.) ₹ 115.00
12mm (2.2mtr.) ₹ 115.00 12mm (2.5mtr.) ₹ 130.00



FOGP-2
8mm (2.2mtr.) ₹ 105.00 8mm (2.5mtr.) ₹ 115.00
10mm (2.2mtr.) ₹ 105.00 10mm (2.5mtr.) ₹ 115.00
12mm (2.2mtr.) ₹ 115.00 12mm (2.5mtr.) ₹ 130.00

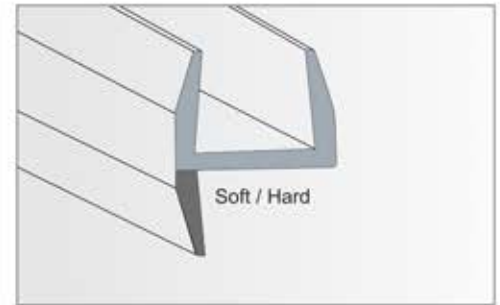

FOGP-3
8mm (2.2mtr.) ₹ 105.00 8mm (2.5mtr.) ₹ 115.00
10mm (2.2mtr.) ₹ 105.00 10mm (2.5mtr.) ₹ 115.00
12mm (2.2mtr.) ₹ 115.00 12mm (2.5mtr.) ₹ 130.00

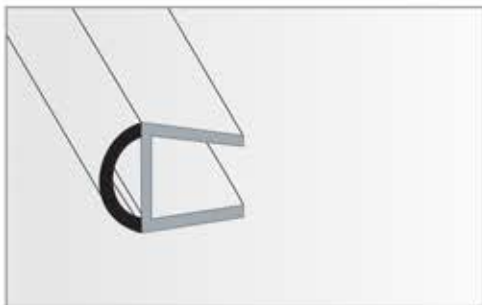

FOGP-4
8mm (2.2mtr.) ₹ 105.00 8mm (2.5mtr.) ₹ 115.00
10mm (2.2mtr.) ₹ 105.00 10mm (2.5mtr.) ₹ 115.00
12mm (2.2mtr.) ₹ 115.00 12mm (2.5mtr.) ₹ 130.00

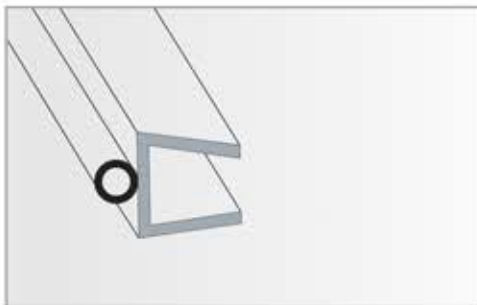

FOGP-5
8mm (2.2mtr.) ₹ 105.00 8mm (2.5mtr.) ₹ 115.00
10mm (2.2mtr.) ₹ 105.00 10mm (2.5mtr.) ₹ 115.00
12mm (2.2mtr.) ₹ 115.00 12mm (2.5mtr.) ₹ 130.00

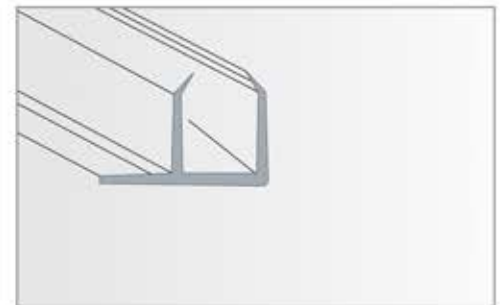

FOGP-6
8mm (2.2mtr.) ₹ 105.00 8mm (2.5mtr.) ₹ 115.00
10mm (2.2mtr.) ₹ 105.00 10mm (2.5mtr.) ₹ 115.00
12mm (2.2mtr.) ₹ 115.00 12mm (2.5mtr.) ₹ 130.00

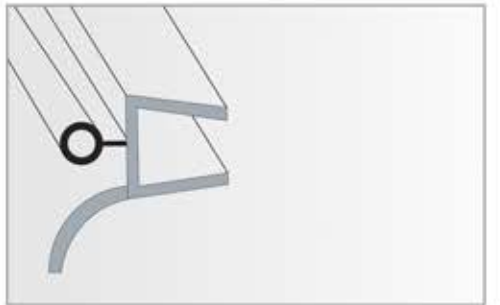

FOGP-7
8mm (2.2mtr.) ₹ 105.00 8mm (2.5mtr.) ₹ 115.00
10mm (2.2mtr.) ₹ 105.00 10mm (2.5mtr.) ₹ 115.00
12mm (2.2mtr.) ₹ 115.00 12mm (2.5mtr.) ₹ 130.00

Magnetic Profiles



FOGP-M1 180°
8mm (2.2mtr.) ₹ 465.00 8mm (2.5mtr.) ₹ 580.00
10mm (2.2mtr.) ₹ 465.00 10mm (2.5mtr.) ₹ 580.00
12mm (2.2mtr.) ₹ 515.00 12mm (2.5mtr.) ₹ 645.00

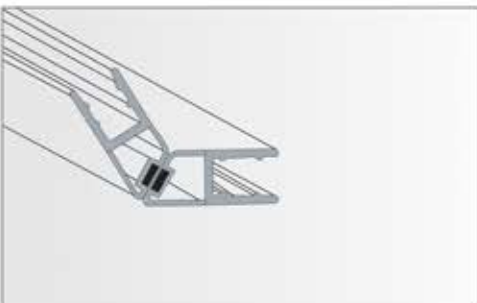

FOGP-M2 135°
8mm (2.2mtr.) ₹ 515.00 8mm (2.5mtr.) ₹ 645.00
10mm (2.2mtr.) ₹ 575.00 10mm (2.5mtr.) ₹ 645.00
12mm (2.2mtr.) ₹ 565.00 12mm (2.5mtr.) ₹ 705.00



FOGP-M3 90°
8mm (2.2mtr.) ₹ 465.00 8mm (2.5mtr.) ₹ 580.00
10mm (2.2mtr.) ₹ 465.00 10mm (2.5mtr.) ₹ 580.00
12mm (2.2mtr.) ₹ 515.00 12mm (2.5mtr.) ₹ 645.00

GLASS CONNECTORS

Round Series

Also Available in
 Rose Gold
 Gold
 Black



FOKH-1
 Wall to Rod (Dia 19mm)
 ₹ 180.00

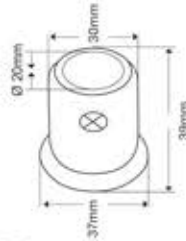

Specification

- Finish : Satin Nikle/Chrome Plated
- Material : Stainless Steel 304 Grade/ Brass
- Reinforcing connector wall to rod



FOKH-2
 Rod to Glass (Dia 19mm)
 ₹ 285.00

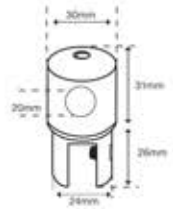

Specification

- Finish : Satin Nikle/Chrome Plated
- Material : Stainless Steel 304 Grade/ Brass
- Reinforcing connector rod to glass



FOKH-3
 Rod to Rod (Dia 19mm)
 ₹ 415.00

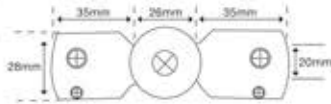

Specification

- Finish : Satin Nikle/Chrome Plated
- Material : Stainless Steel 304 Grade/ Brass
- Reinforcing connector rod to rod (Adjustable Angle)



FOKH-4
 Rod to Glass (One Side Blind)
 ₹ 310.00

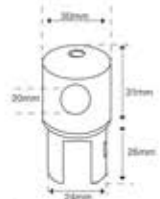

Specification

- Finish : Satin Nikle/Chrome Plated
- Material : Stainless Steel 304 Grade/ Brass
- Reinforcing connector rod to glass (One side blind)



FOKH-5
 Rod to Rod T Connector (Dia 19mm)
 ₹ 415.00

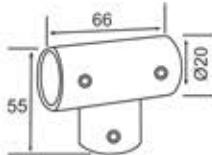

Specification

- Finish : Satin Nikle/Chrome Plated
- Material : Stainless Steel 304 Grade/ Brass
- Reinforcing connector rod to rod (T-Type)



FOKH-ACC-19
 Reinforcing Rod (Dia 19mm)
 ₹ 115.00 (19mm)
 ₹ 165.00 (25mm)

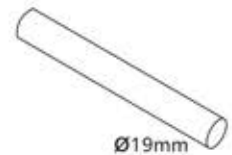

Specification

- 19mm outer diameter pipe
- Available in 2 & 3 mtr. length
- Material : Stainless Steel 304 Grade

Square Series



FOKH-11
 Wall to Rod (Dia 25mm)
 ₹ 300.00

Specification

- Finish : Satin Nikle/Chrome Plated
- Material : Stainless Steel 304 Grade
- Reinforcing connector wall to rod



FOKH-22
 Rod to Glass (Dia 25mm)
 ₹ 560.00

Specification

- Finish : Satin Nikle/Chrome Plated
- Material : SS 304 Grade
- Reinforcing connector rod to glass



FOKH-33
 Rod to Rod (Dia 25mm)
 ₹ 930.00

Specification

- Finish : Satin Nikle/Chrome Plated
- Material : SS 304 Grade
- Reinforcing connector rod to rod (Adjustable Angle)



FOKH-44
 Rod to Glass
 (One Side Blind)
 ₹ 500.00

Specification

- Finish : Satin Nikle/Chrome Plated
- Material : SS 304 Grade
- Reinforcing connector rod to glass (One side blind)



FOKH-55
 Rod to Rod T Connector
 (Dia 25mm)
 ₹ 835.00

Specification

- Finish : Satin Nikle/Chrome Plated
- Material : SS 304 Grade
- Reinforcing connector rod to rod (T-Type)



FOKH-ACC-25x25
 Connecting Track
 ₹ 835.00 per ft.

Specification

- 25mm outer diameter pipe
- Available in 2 & 3 mtr. length
- Material : Stainless Steel 304 Grade

PLASTIC PROFILES

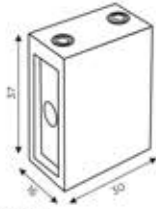

FOKH-111
Wall to Track Connector
₹ 565.00

- Specification**
- For mounting with wall
 - Rectangular design
 - With two grub screws to prevent relative movement
 - Material : SS 304 Grade

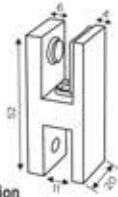

FOKH-222
Track to Glass Connector
₹ 565.00

- Specification**
- For mounting with wall
 - Rectangular design
 - With two grub screws to prevent relative movement
 - Material : SS 304 Grade

Also Available in
Rose Gold Gold Black

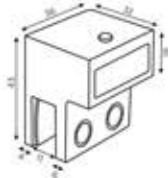

FOKH-333
Track to Track Connector
₹ 1030.00

- Specification**
- Glass to track end connector
 - With two grub screws to prevent relative movement
 - Material : SS 304 Grade



FOKH-ACC-10/30
Connecting Track
(Available in 1.5 Mt, 1.8 Mt & 2.1 Mt)
₹ 220.00 per ft.

- Specification** Ø10x30mm
- Rectangular design
 - Available in 1.5, 1.8, 2.1 mtr. length
 - Material : SS 304 Grade

DOOR KNOBS



FODK-1
Door Knob
₹ 415.00



FODK-2
Door Knob
₹ 415.00



FODK-22
Door Knob
₹ 415.00



FODK-44
Door Knob
₹ 415.00

SHOWER SLIDING SYSTEM



₹ 5400.00 Set (CP Finish)

- FOSL-11-A1 | 2 Big Roller, 2 Small Roller
- FOSL-11-A2 | 2 Track to Glass Holder
- FOSL-11-A3 | 2 Stopper
- FOSL-11-A4 | 1 Floor Guide
- FOSL-1 | 2 Wall to Track Connector
- FOSL-HN-50 | 1 Sliding Handle

FOKH-ACC-10/30
Connecting Track
₹ 245.00 (Per Ft.)



NEW



₹ 9000.00 Set (Black Matt)

- FOSL-11-A1 | 2 Big Roller, 2 Small Roller
- FOSL-11-A2 | 2 Track to Glass Holder
- DFSL-11-A3 | 2 Stopper
- FOSL-11-A4 | 1 Floor Guide
- FOSL-1 | 2 Wall to Track Connector
- FOSL-HN-50 | 1 Sliding Handle

FOKH-ACC-10/30
Connecting Track
₹ 400.00 (Per Ft.)



NEW



₹ 9000.00 Set (Rose Gold)

- FOSL-11-A1 | 2 Big Roller, 2 Small Roller
- FOSL-11-A2 | 2 Track to Glass Holder
- FOSL-11-A3 | 2 Stopper
- FOSL-11-A4 | 1 Floor Guide
- FOSL-1 | 2 Wall to Track Connector
- FOSL-HN-50 | 1 Sliding Handle

FOKH-ACC-10/30
Connecting Track
₹ 400.00 (Per Ft.)



NEW



₹ 9000.00 Set (Gold)

- FOSL-11-A1 | 2 Big Roller, 2 Small Roller
- FOSL-11-A2 | 2 Track to Glass Holder
- FOSL-11-A3 | 2 Stopper
- FOSL-11-A4 | 1 Floor Guide
- FOSL-1 | 2 Wall to Track Connector
- FOSL-HN-50 | 1 Sliding Handle

FOKH-ACC-10/30
Connecting Track
₹ 400.00 (Per Ft.)



OFFICE SLIDING SYSTEM

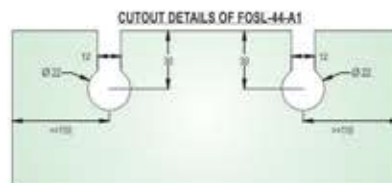

FOSSL-44-A1 (One Box Contains)
2 set Rollers (S.S.)
2 set Stoppers
1 Floor Guides
₹ 1800.00

- Specification**
- Four fiber reinforced plastic rollers of 30 mm diameter
 - Stainless Steel Grade 304 glass holding point
 - Height adjustable glass holding points (10 mm)
 - Secure grip for the door
 - Self aligning suspension of door
 - Roller configuration for even distribution of load
 - Independently connected rollers to prevent damage to track and rollers
 - Suitable for 10 mm or 12 mm glass
 - Suitable for door weight 40 kg.

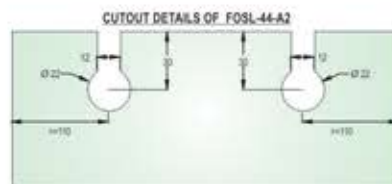

FOSSL-44-A2 (One Box Contains)
2 set Rollers (S.S.)
2 set Stoppers
1 Floor Guides
₹ 2315.00

- Specification**
- Heavy duty sliding door roller
 - Suitable for up to a door weight of 80 Kg
 - Larger surface area for secure grip of the door
 - Adjustable threaded rod for installation perfection
 - Solid brass for glass holding



FOSSL-44-R8 (One Box Contains)
2 set 8 Wheel Rect. Rollers (S.S.)
2 set Stoppers
1 Floor Guides
₹ 1675.00

- Specification**
- Material : Stainless steel 304 grade
 - Finish : Satin stainless steel (SSS)

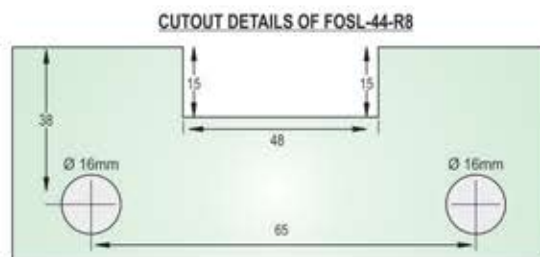

FOSSL-A11
8 Wheel Both Side Soft Close Sliding Fitting (Round)
₹ 4200.00 (Set)



FOSSL-A22
8 Wheel Both Side Soft Close Sliding Fitting (Big Round)
₹ 4770.00 (Set)

OFFICE SLIDING SYSTEM

OFFICE AND RESIDENTIAL SLIDING ROLLER FOR WOODEN



FOSL-WD-80 | Sliding System Set
W/O Track for Single Frameless Door of 80 kg
₹ 710.00



FOSL-WD-100 | Sliding System Set
W/O Track for Single Frameless/Wooden Door of 100 kg
₹ 900.00



FOSL-44-A5
Wall to Track Clamp
₹ 115.00



FOSL-44-A6
Glass to Track Clamp
₹ 575.00 per pc.



FOSL-HN-50
Sliding Handle (Dia 50mm)
₹ 415.00



FOSL-HN-60
Sliding Handle (Dia 60mm)
₹ 360.00



FOSL-HN-70
Sliding Handle (Square)
₹ 1150.00



FOSL-HN-80
Sliding Handle (Rectangle)
₹ 1415.00



FOSL-33G
Floor Guide
₹ 220.00



FOSL-44-A8
90° Track Connector
₹ 115.00



FOSL-44-A9
Wall to Track Connector
₹ 185.00



FOSDL-13A+13C
Sliding Door Lock with Strike Plate
₹ 5625.00



FOSDL-13A+13B
Sliding Door Lock
₹ 7200.00



FOSDL-13D
Strike Box
For Over Lap Glass
₹ 1800.00

SPARKLE FINISH



FOSL-44-B1
Aluminium Track (Single)
Available in 8, 10 & 13 Ft.
₹ 270.00 per ft.

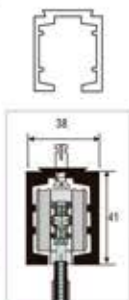

FOSL-44-B2
Aluminium Track (Door+Fix Glass)
Available in 8, 10 & 13 Ft.
₹ 325.00 per ft.



FOSL-44-B3
Aluminium Track (Double Door)
Available in 8, 10 & 13 Ft.
₹ 450.00 per ft.

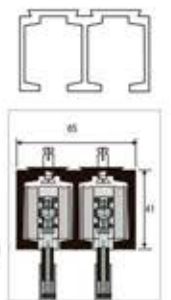

FOL-LK-G
Sliding Door Lock (Glass to Glass)
₹ 2200.00



FOL-LK-W
Sliding Door Lock (Wall to Glass)
₹ 2070.00



FODL-14
Sliding Door Lock with Sliding Handle
₹ 7740.00



SLIDING DOOR SYSTEM



₹ 8300.00 Set

- FOSL-33A | 2 Sliding Roller
- FOSL-33-TH-G2 | 4 Glass to Rod Clamp
- FOSL-33G | 1 Floor Guide
- FOSL-33B | 2 (L R) Door Stopper
- 2 Cap + 1 Fastner



FOSL-33A
Office Sliding Roller

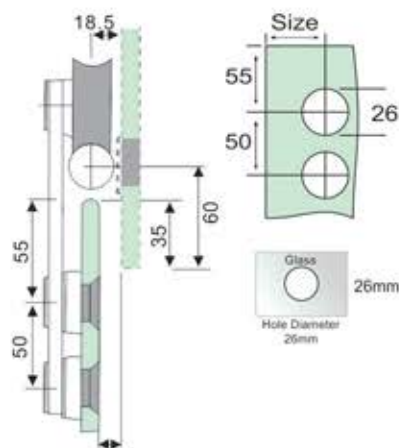

FOSL-33-TH-WL
Wall to Rod Holder
₹ 775.00



FOSL-33-TH-G2
Glass to Rod Clamp
₹ 900.00



FOSL-33G
Floor Guide
₹ 220.00



FOSL-33B
Door Stopper
₹ 775.00



FOSL-33-TH
Wall to Rod Clamp
₹ 775.00



FOSL-33H
Glass to Glass Connector 180°
₹ 1415.00

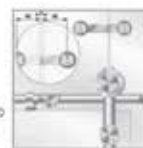

FOSL-ACC-25
Shower Sliding Pipe
₹ 165.00 (25mm)

SLIDING FOLDING SYSTEM



FOSFS-A6
Glass to Glass Center Hinge
₹ 4900.00



FOSFS-A9
Wall to Glass Hinge
₹ 3550.00

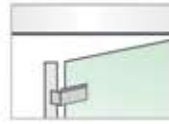

FOSFS-A10
Center Hinge with Roller
₹ 6120.00



FOSFS-A11
End Hinge with Roller
₹ 4110.00

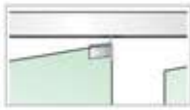

FOSFS-A12
Glass to Glass Center Hinge with Guide
₹ 8100.00



FOSFS-A13 L/R
Glass to Glass Center Hinge with Lock
₹ 4815.00



FOSFS-A14
End Hinge with Guide
₹ 2700.00



FOSFS-A16
Fixed Hinge
₹ 2890.00

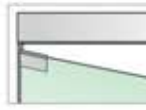

FOSFS-A17
Floor Fixed Hinge
₹ 2890.00



FOSFS-1
Floor Track Bottom (S.S.)
₹ 325.00 per ft.



FOSFS-2
Aluminium Track (Top)
Available in 4 Mt.
₹ 270.00 per ft.

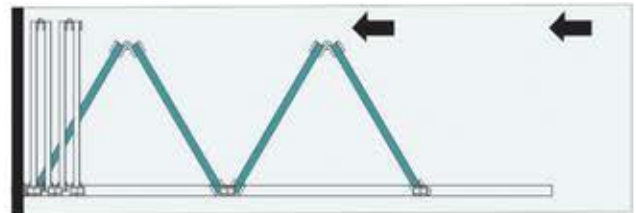

Note :-

- Maximum weight per door : 70kg
- Maximum width per door : 900mm
- Maximum height per door : 2500mm
- Suitable for 8 to 10mm glass thickness

Specification

- Track for sliding folding door system to be mounted to the ceiling and floor

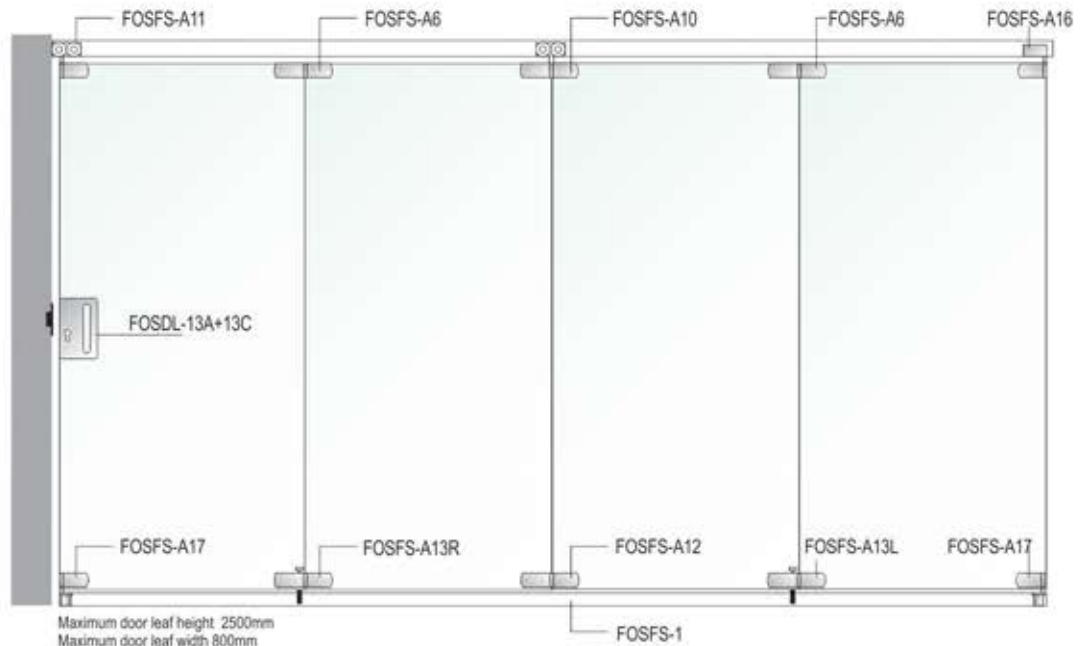

Maximum door leaf height : 2500mm
Maximum door leaf width : 800mm
Maximum door leaf load : 60mm

MANET SLIDING SYSTEM



₹ 9900.00 Set

- FOLM-D22 | 2 Roller
- FOSL-11-A3 | 2 Stopper
- FOSL-11-A4 | 1 Floor Guide
- FOSL-1-A2 Wall to Track Connector
- FOSL-HN-50 | 1 Sliding Handle



FOSLM-D22
Folding Door Roller



FOSL-11-A2
wall to Track Connector



FOSL-11-A3
Stopper



FOSL-11-A6
Track to Glass Holder



FOSL-11-A4
Floor Guide



FOSL-HN-50
Sliding Handle



SLIDING FOLDING SYSTEM

NEW



Knob Clamp Roller (SS)



Track Mounting Bracket



Track to Track 90° Bracket (Extra)



Floor Guide



Door Stopper



FOSL-44 Set

Top Track

₹ 5175.00 (Complete Set with 2 mtr. track)

₹ 7750.00 (Complete Set with 4 mtr. track)

₹ 9300.00 (Double Door Complete Set with 4 mtr. track)



FOSL-44 Set

Top Track (Gold)

₹ 7750.00 (Complete Set with 2 mtr. track)

₹ 10300.00 (Complete Set with 4 mtr. track)

₹ 11900.00 (Double Door Complete Set with 4 mtr. track)



FOSL-44 Set

Top Track (Rose Gold)

₹ 7750.00 (Complete Set with 2 mtr. track)

₹ 10300.00 (Complete Set with 4 mtr. track)

₹ 11900.00 (Double Door Complete Set with 4 mtr. track)



FOSL-44 Set

Top Track (Black Matt)

₹ 8600.00 (Complete Set with 2 mtr. track)

₹ 11450.00 (Complete Set with 4 mtr. track)

₹ 13200.00 (Double Door Complete Set with 4 mtr. track)

CANOPY FITTING

* Customized solutions can be provided according to the requirements of projects.



FOCF-1
Wall to Glass Connector
₹ 1410.00

Specification

- Finish : Satin stainless steel (SSS)
- Suitable for canopies in interior & exterior
- Stainless steel 304 grade
- To fix glass with the wall
- Adjustable angle
- Washer to prevent glass from damage

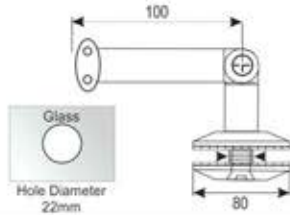

FOCF-2
Rod to Glass Connector
₹ 1410.00

Specification

- Finish : Satin stainless steel (SSS)
- Suitable for holding canopy glass with rod along with wall to rod
- Stainless steel 304 grade
- To hold canopy glass with rod
- Adjustable angle
- Washer to prevent glass from damage

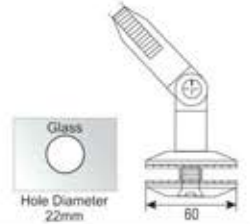

FOCF-3
Wall to Rod Connector
₹ 1170.00

Specification

- Finish : Satin stainless steel (SSS)
- Suitable for holding wall to rod with wall
- Stainless steel 304 grade
- To hold rod with the wall
- Adjustable angle
- Washer to prevent glass from damage

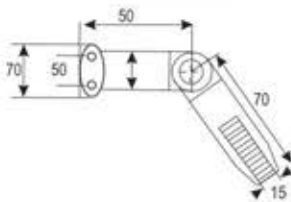

FOCF-ROD (16mm)
Canopy Rod with Thread
₹ 410.00 per Feet

Specification

- Finish : Satin stainless steel (SSS)
- Suitable for fixing with pivot pole (top)
- Stainless steel 304 grade
- To be fix to a secured over panel
- Available with countersunk/flat head



POINT FIXED GLASS CONNECTORS



FOPC-1
Wall to Glass (Adjustable)
(Available in 82mm & 103mm)
₹ 1475.00



FOPC-1A
Wall to Glass (Fix)
(Available in 82mm & 103mm)
₹ 1410.00



FOPC-2
Glass to Glass (Adjustable)
(Available in 82mm & 103mm)
₹ 1675.00



FOPC-2A
Glass to Glass (Adjustable with Fin)
(Available in 82mm & 103mm)
₹ 2100.00



SLIDING FOLDING SYSTEM

Spiders Without Fin (available In 200mm & 220mm Arm Distance)
Available in SS 316



FOSF-A4
Four Way Spider
₹ 3475.00

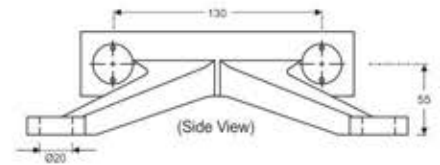
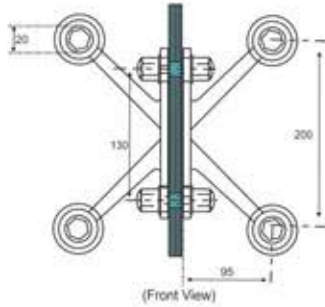

Specification

- Four Way Spider with fin to suit two/four panel glass assembly
- With gasket & teflon washers to prevent glass from damage
- Hold glass with the help of articulated/fix routels



FOSF-A2
Two Way Spider
₹ 2610.00

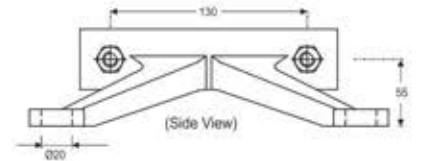
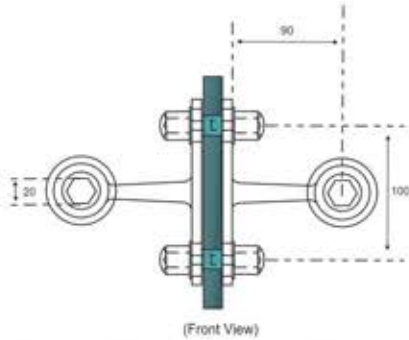

Specification

- Two Way Spider with fin to suit two panel glass assembly
- With gasket & teflon washers to prevent glass from damage
- Hold glass with the help of articulated/fix routels



FOSF-A44
Two Way Spider (Wall Mounted)
₹ 1800.00

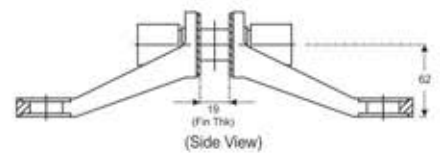
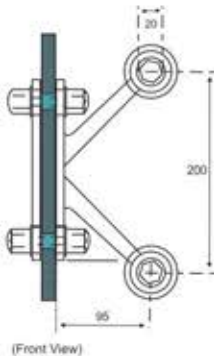

Specification

- Two Way Spider with fin to suit two panel wall assembly
- With gasket & teflon washers to prevent glass from damage
- Hold glass with the help of articulated/fix routels



FOSF-A22
One Way Spider (Wall Mounted)
₹ 1440.00

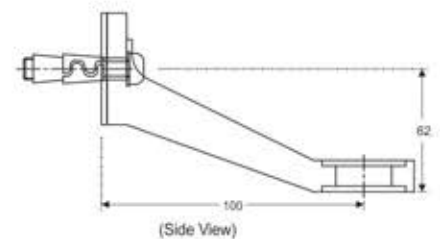
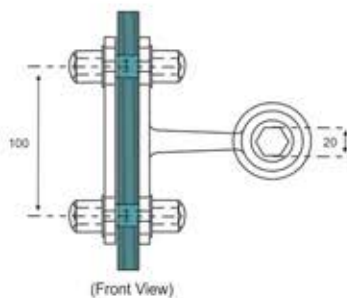

Specification

- One Way Spider with fin to suit one panel wall assembly
- With gasket & teflon washers to prevent glass from damage
- Hold glass with the help of articulated/fix routels

SPIDER FITTING

Spiders Without Fin (available In 200mm & 220mm Arm Distance)
Available in **SS 316**



FOSF-B1
One Way Spider without Fin
₹ 1620.00

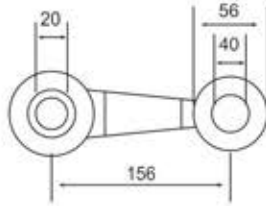

Specification

- 160 mm arm
- One Way Spider without fin to hold the glass at one point
- Material : **Stainless Steel 316 Grade**
- Hold glass with the help of articulated/fix routel.
- Designed to hold with fix structure



FOSF-B2 (90°)
Two Way Spider without Fin
₹ 2200.00

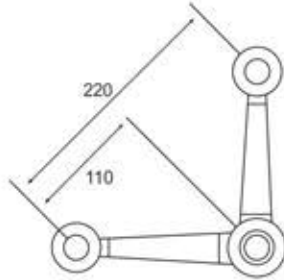

Specification

- Two Way Spider without fin to hold two glass panels at 90° with fixed structure.
- Material : **Stainless Steel 316 Grade**
- Hold glass with the help of articulated/fix routels.
- Designed to hold with fix structure



FOSF-B2 (180°)
Two Way Spider without Fin
₹ 2070.00

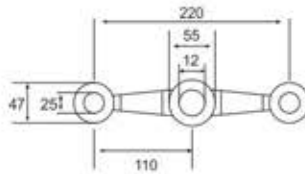

Specification

- 220 mm arm
- Two Way Spider without fin to hold two glass panels at 180° with fixed structure.
- Material : **Stainless Steel 316 Grade**
- Hold glass with the help of articulated/fix routels.
- Designed to hold with fix structure



FOSF-B3 (180°)
Three Way Spider without Fin
₹ on request

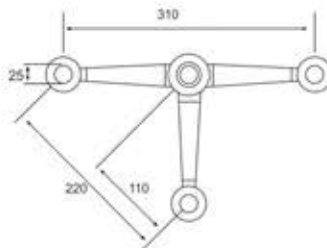

Specification

- Three Way Spider without fin to hold three glass panels
- Material : **Stainless Steel 316 Grade**
- Hold glass with the help of articulated/fix routels.
- Designed to hold with fix structure



FOSF-B4
Four Way Spider without Fin
₹ 3475.00

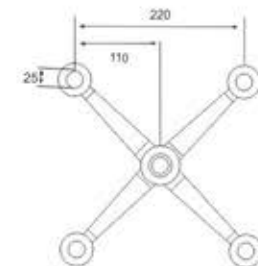

Specification

- Four Way Spider without fin to hold four glass panel together with fixed structure
- Material : **Stainless Steel 316 Grade**
- Hold glass with the help of articulated/fix routel.
- Designed to hold with fix structure



FOSF-B5
Four Way Spider without Fin for 90° corner
₹ 5400.00

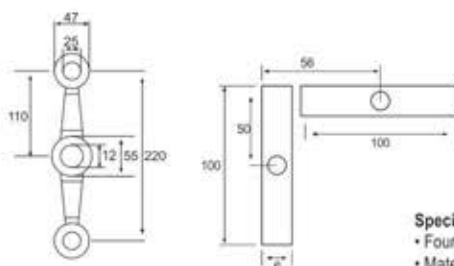

Specification

- Four Way Spider without fin 90° to hold four glass panel together with fixed structure
- Material : **Stainless Steel 316 Grade**
- Hold glass with the help of articulated/fix routel
- Designed to hold with fix structure

POINT SPIDER WITH FIN

(Point Spider) Available in SS 316



FOSP-D22
One Way Spider for Wall/Ceiling
₹ 2300.00

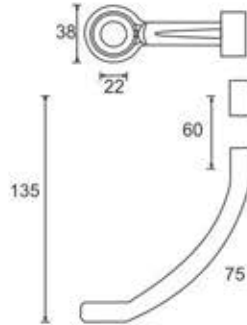

Specification

- One Way Spider with fin to suit two/four panel glass assembly
- With gasket & teflon washers to prevent glass from damage
- Hold glass with the help of articulated/fix routels



FOSP-D44
Two Way Spider 90° for Wall/Ceiling
₹ 2700.00

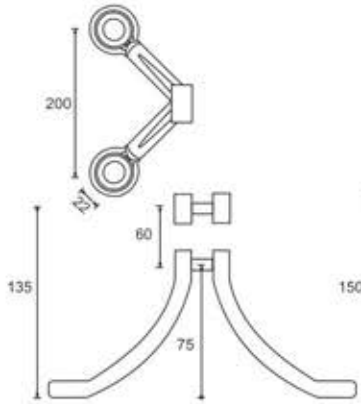

Specification

- Two Way Spider with fin to suit two panel glass assembly
- With gasket & teflon washers to prevent glass from damage
- Hold glass with the help of articulated/fix routels



FOSP-D2
Two Way Spider 180° with Fin
₹ 4140.00

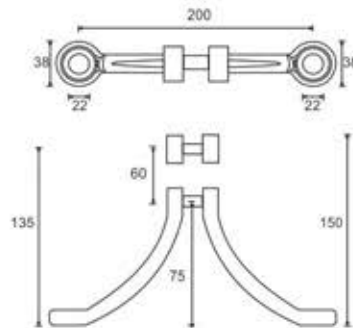

Specification

- Two Way Spider with fin to suit two panel wall assembly
- With gasket & teflon washers to prevent glass from damage
- Hold glass with the help of articulated/fix routels



FOSP-D4
Four Way Spider with Fin
₹ 4640.00

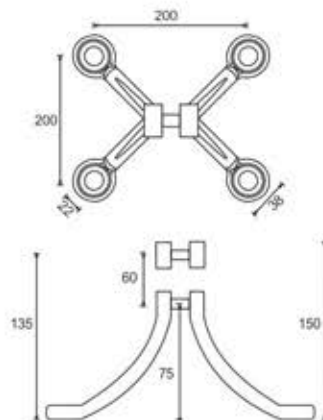

Specification

- Four Way Spider with fin to suit one panel wall assembly
- With gasket & teflon washers to prevent glass from damage
- Hold glass with the help of articulated/fix routels

POINT SPIDER WITH FIN

(Point Spider) Available in SS 316

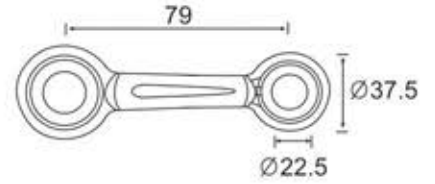
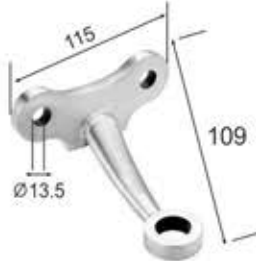

FOSP-1
One Way Spider for Wall/Ceiling
₹ 1940.00

- Specification**
- One Way Spider with fin to suit two/four panel glass assembly
 - With gasket & teflon washers to prevent glass from damage
 - Hold glass with the help of articulated/fix routels

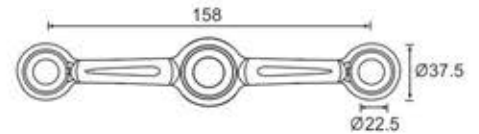

FOSP-2
Two Way Spider 180° with Fin
₹ 3740.00

- Specification**
- Two Way Spider with fin to suit two panel glass assembly
 - With gasket & teflon washers to prevent glass from damage
 - Hold glass with the help of articulated/fix routels

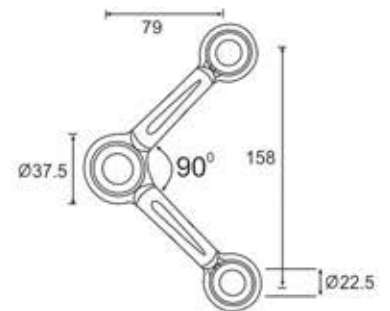
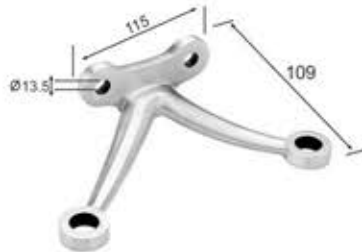

FOSP-2A
Two Way Spider 90° for Wall/Ceiling
₹ 2700.00

- Specification**
- Two Way Spider with fin to suit two panel wall assembly
 - With gasket & teflon washers to prevent glass from damage
 - Hold glass with the help of articulated/fix routels

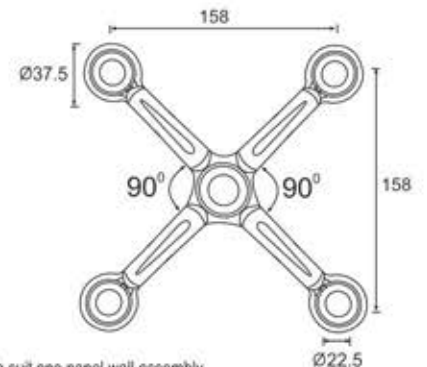
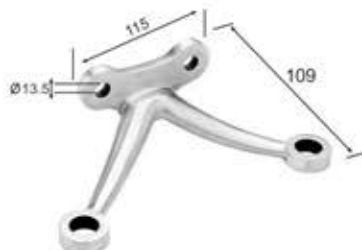

FOSP-4
Four Way Spider with Fin
₹ 5200.00

- Specification**
- Four Way Spider with fin to suit one panel wall assembly
 - With gasket & teflon washers to prevent glass from damage
 - Hold glass with the help of articulated/fix routels

Please refer to actual product for hole preparation. Customized solutions can be provided according to the requirements of the project. (Spider, Fin / Splice Plates & Routels)

ARTICULATED ROUTEL



FOSP-AFB 36FL
Articulated Routel (Flat Head)
₹ 850.00

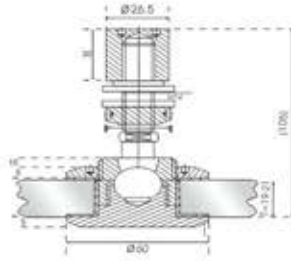

Specification

- Articulated flat head routel to be used along with spiders to hole glass
- Material : **Stainless Steel 316 Grade**
- With teflon washers to prevent glass from damage
- Adjustable upto 15mm glass thickness



FOSP-AFB 36CS
Articulated Routel (Counter Sunk Hole)
₹ 850.00

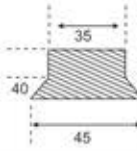
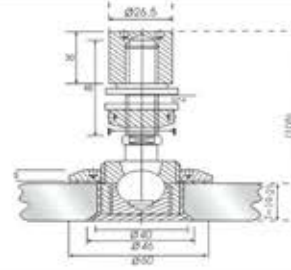

Specification

- Articulated Counter Sunk routel to be used along with spiders to hole glass
- Material : **Stainless Steel 316 Grade**
- With teflon washers to prevent glass from damage
- Adjustable upto 15mm glass thickness



FOSP-FB FL
Fixed Routel (Flat Head)
₹ 705.00

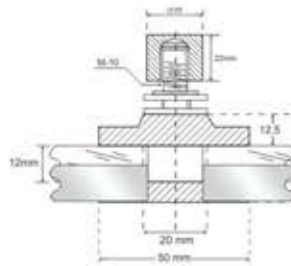

Specification

- Countersunk head routel to be used along with spiders to hold glass
- Material : **Stainless Steel 316 Grade**
- With teflon washers to prevent glass from damage



FOSP-FB CS
Fixed Routel (Counter Sunk)
₹ 705.00

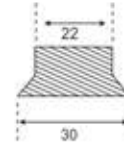
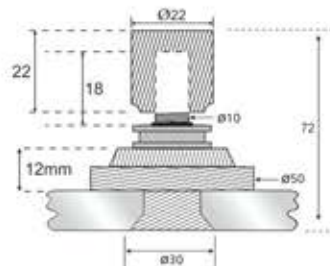

Specification

- Fixed flat head routel to be used along with spiders to hold glass
- Material : **Stainless Steel 316 Grade**
- With teflon washers to prevent glass from damage
- Adjustable to glass thickness
- Smaller in sizes



FOSP-RB (FH/CS)
Rigid Bolt (Flat Head/Counter Sunk)
₹ 540.00

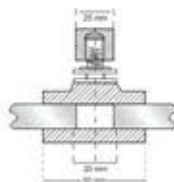

Specification

- Rigid Bolt to be used along with spiders to hole glass
- Material : **Stainless Steel 316 Grade**
- With teflon washers to prevent glass from damage
- Adjustable upto 15mm glass thickness



FOSP-01
Iron Assembly
₹ 705.00

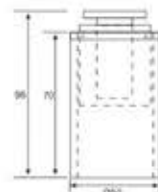

Specification

- Fixing bolt helps to hold without fin spiders with fix structure
- Material : **Stainless Steel 316 Grade**
- Adjustable height for accurate fixing of spider with flat head



FOSP-FBM
Fixed Bolt (Mini)
SS 316/304 Satin Finish
₹ 580.00



NEW

FOSP-FBM A
Fixed Bolt (Mini)
SS 316/304 Satin Finish
₹ 580.00



FIN PLATES & SPLICE PLATES

(Point Spider) Available in SS 316

FIN PLATES

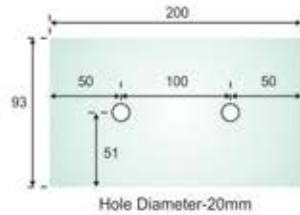

FOFP-200
Fin Plate 200mm
₹ 3990.00

- Specification**
- Two point holding of fin
 - Finish : Satin Stainless Steel (SSS)
 - Material : **Stainless Steel 316 Grade**
 - With teflon washers to prevent glass from damage

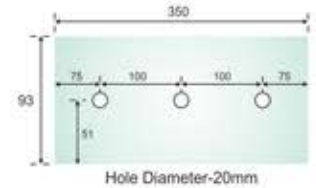

FOFP-300
Fin Plate 300mm
₹ 4760.00

- Specification**
- Three point holding of fin
 - Finish : Satin Stainless Steel (SSS)
 - Material : **Stainless Steel 316 Grade**
 - With teflon washers to prevent glass from damage

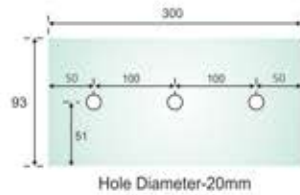

FOFP-350
Fin Plate 350mm
₹ 5140.00

- Specification**
- Three point holding of fin
 - Finish : Satin Stainless Steel (SSS)
 - Material : **Stainless Steel 316 Grade**
 - With teflon washers to prevent glass from damage

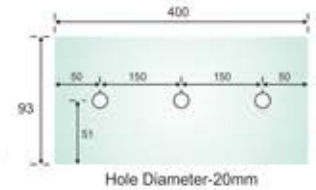

FOFP-400
Fin Plate 400mm
₹ 5530.00

- Specification**
- Three point holding of fin
 - Finish : Satin Stainless Steel (SSS)
 - Material : **Stainless Steel 316 Grade**
 - With teflon washers to prevent glass from damage

SPLICE PLATES

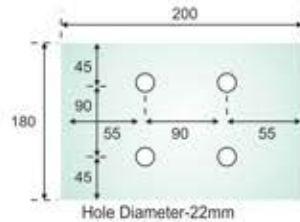

FOSP-200
Splice Plate 200mm
₹ 4860.00

- Specification**
- Two point holding with each fin part
 - Finish : Satin Stainless Steel (SSS)
 - Material : **Stainless Steel 316 Grade**
 - With teflon washers to prevent glass from damage

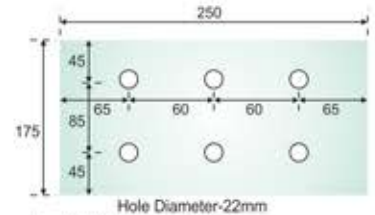

FOSP-250
Splice Plate 250mm
₹ 4760.00

- Specification**
- Three point holding with each fin part
 - Finish : Satin Stainless Steel (SSS)
 - Material : **Stainless Steel 316 Grade**
 - With teflon washers to prevent glass from damage

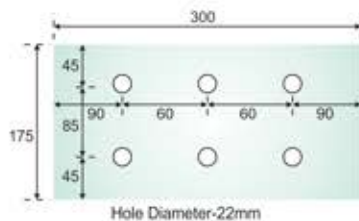

FOSP-300
Splice Plate 300mm
₹ 4375.00

- Specification**
- Three point holding with each fin part
 - Finish : Satin Stainless Steel (SSS)
 - Material : **Stainless Steel 316 Grade**
 - With teflon washers to prevent glass from damage

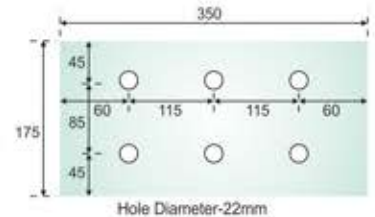

FOSP-350
Splice Plate 350mm
₹ 5530.00

- Specification**
- Three point holding with each fin part
 - Finish : Satin Stainless Steel (SSS)
 - Material : **Stainless Steel 316 Grade**
 - With teflon washers to prevent glass from damage

DOOR CLOSER



Specification

- Applicable door width : 500-1000mm
- Applicable door weight **upto 40-45kg**
- Adjustable section of closing speed 180°-20°
- Adjustable section of latching speed 20°-0°
- The door closer is suitable for installing in various doors, such as wooden door, metal door, etc
- The door closer can be chosen to stop or unstop at will
- Continuous adjustment of closing and latching speed: the fast speed can be adjusted to within 3 seconds from 90 degree, slowness close can reach to 60 seconds or more

FODC-1001
Door Closer (Eco)
Door Weight Capacity : 40-45 kg
₹ 990.00



Specification

- Applicable door width : 600-1200mm
- Applicable door weight **upto 60-65kg**
- Adjustable section of closing speed 180°-20°
- Adjustable section of latching speed 20°-0°
- The door closer is suitable for installing in various doors, such as wooden door, metal door, etc
- The door closer can be chosen to stop or unstop at will
- Continuous adjustment of closing and latching speed: the fast speed can be adjusted to within 3 seconds from 90 degree, slowness close can reach to 60 seconds or more

FODC-1002
Door Closer (Classic)
Door Weight Capacity : 60-65 kg
₹ 1125.00



Specification

- Applicable door width : 800-1100mm
- Applicable door weight **upto 40-65kg**
- Adjustable section of closing speed 180°-20°
- Adjustable section of latching speed 20°-0°
- The door closer is suitable for installing in various doors, such as wooden door, metal door, etc
- The door closer can be chosen to stop or unstop at will
- Continuous adjustment of closing and latching speed: the fast speed can be adjusted to within 3 seconds from 90 degree, slowness close can reach to 60 seconds or more

FODC-1003
Door Closer (Sleek)
Door Weight Capacity : 40-65 kg
₹ 1800.00



Specification

- Applicable door width : 500-1200mm
- Applicable door weight **upto 30-65kg**
- With pelmet arm for hold open function
- Separate stainless steel plate for attractive look
- Adjustable section of closing speed 180°-20°
- Adjustable section of latching speed 20°-0°
- The door closer is suitable for installing in various doors, such as wooden door, metal door, etc
- The installation modes of vertical, parallel and slide-rail type all can be chosen at will
- Continuous adjustment of closing and latching speed: the fast speed can be adjusted to within 3 seconds from 90 degree, slowness close can reach to 60 seconds or more

FODC-1004
Door Closer (Pelmet)
Door Weight Capacity : 35-65 kg
₹ 2700.00

Door Closer Installation Flow

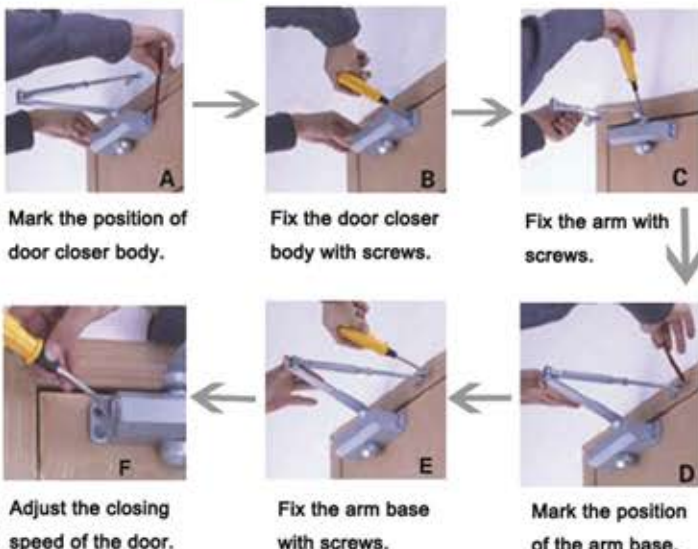

Specification

FODC-1005
Door Closer (Concealed)
Door Weight Capacity : 30-65 kg
₹ 3780.00

Specification

- Applicable door width : 500-1200mm
- Applicable door weight **upto 30-65kg**
- With pelmet arm for hold open function
- Fit into inside wooden, metal doors.
- Adjustable section of closing speed 180°-20°
- Adjustable section of latching speed 20°-0°
- The door closer is suitable for installing in various doors, such as wooden door, metal door, etc
- The installation modes of vertical, parallel and slide-rail type all can be chosen at will
- Continuous adjustment of closing and latching speed: the fast speed can be adjusted to within 3 seconds from 90 degree, slowness close can reach to 60 seconds or more

LOCKS WITHOUT CUTOUT

SS 304 Grade



FOLK-1
Double Door Lock (Only Key)
₹ 975.00

Specification

- Material : Stainless steel
- Finish : Satin stainless steel
- One side key-Lock from outside only
- Suitable for 10/12mm Glass
- Glass preparation/cutout not required
- With gasket to prevent glass from damage
- With three bass computer key
- Suitable for glass to glass



FOLK-2
Single Door Lock (Only Key)
₹ 1150.00

Specification

- Material : Stainless steel
- Finish : Satin stainless steel
- One side key-Lock from outside only
- Suitable for 10/12mm Glass
- Glass preparation/cutout not required
- With gasket to prevent glass from damage
- With three bass computer key
- Suitable for glass to wall/fix structure



FOLK-3
Double Door Lock (Key & Knob)
₹ 1150.00

Specification

- Material : Stainless steel
- Finish : Satin stainless steel
- One side key-Lock from outside only
- Suitable for 10/12mm Glass
- Glass preparation/cutout not required
- With gasket to prevent glass from damage
- With three bass computer key
- Suitable for glass to glass



FOLK-4
Single Door Lock (Key & Knob)
₹ 1030.00

Specification

- Material : Stainless steel
- Finish : Satin stainless steel
- One side key-Lock from outside only
- Suitable for 10/12mm Glass
- Glass preparation/cutout not required
- With gasket to prevent glass from damage
- With three bass computer key
- Suitable for glass to wall/fix structure



FOLK-5
Double Door Lock (Only Key)
₹ 1030.00

Specification

- Material : Stainless steel
- Finish : Satin stainless steel
- One side key-Lock from outside only
- Suitable for 10/12mm Glass
- Glass preparation/cutout not required
- With gasket to prevent glass from damage
- With three bass computer key
- Suitable for glass to glass



FOLK-6
Single Door Lock (Only Key)
₹ 1150.00

Specification

- Material : Stainless steel
- Finish : Satin stainless steel
- One side key-Lock from outside only
- Suitable for 10/12mm Glass
- Glass preparation/cutout not required
- With gasket to prevent glass from damage
- With three bass computer key
- Suitable for glass to wall/fix structure



FOLK-7
Double Door Lock (Key & Knob)
₹ 1220.00

Specification

- Material : Stainless steel
- Finish : Satin stainless steel
- One side key/one side knob
- Suitable for 10/12mm Glass
- Glass preparation/cutout not required
- With gasket to prevent glass from damage
- With three bass computer key
- Suitable for glass to glass



FOLK-8
Single Door Lock (Key & Knob)
₹ 1090.00

Specification

- Material : Stainless steel
- Finish : Satin stainless steel
- One side key/one side knob
- Suitable for 10/12mm Glass
- Glass preparation/cutout not required
- With gasket to prevent glass from damage
- With three bass computer key
- Suitable for glass to wall/fix structure



FOLK-9 (Slot Type)
Mini Double Door Lock (Key & Knob)
₹ 1090.00

Specification

- Material : Stainless steel
- Finish : Satin stainless steel
- One side knob only
- Suitable for 10/12mm Glass
- Glass preparation/cutout not required
- With gasket to prevent glass from damage
- With three bass computer key
- Suitable for glass to glass



FOLK-10 (Slot Type)
Mini Single Door Lock (Key & Knob)
₹ 1220.00

Specification

- Material : Stainless steel
- Finish : Satin stainless steel
- One side knob only
- Suitable for 10/12mm Glass
- Glass preparation/cutout not required
- With gasket to prevent glass from damage
- With three bass computer key
- Suitable for glass to wall/fix structure



FOLK-11 (Pin Type)
Mini Double Door Lock (Key & Knob)
₹ 1090.00

Specification

- Material : Stainless steel
- Finish : Satin stainless steel
- One side knob only
- Suitable for 10/12mm Glass
- Glass preparation/cutout not required
- With gasket to prevent glass from damage
- With three bass computer key
- Suitable for glass to glass



FOLK-12 (Pin Type)
Mini Single Door Lock (Key & Knob)
₹ 1220.00

Specification

- Material : Stainless steel
- Finish : Satin stainless steel
- One side knob only
- Suitable for 10/12mm Glass
- Glass preparation/cutout not required
- With gasket to prevent glass from damage
- With three bass computer key
- Suitable for glass to wall/fix structure



FOLK-13
Single Door Lock (Only Knob)
₹ 835.00

Specification

- Material : Stainless steel
- Finish : Satin stainless steel
- One knob only
- Suitable for 10/12mm Glass
- Glass preparation/cutout not required
- With gasket to prevent glass from damage
- With three bass computer key
- Suitable for glass to glass



FOLK-14
Single Door Lock (Only Knob)
₹ 835.00

Specification

- Material : Stainless steel
- Finish : Satin stainless steel
- One side knob only
- Suitable for 10/12mm Glass
- Glass preparation/cutout not required
- With gasket to prevent glass from damage
- With three bass computer key
- Suitable for glass to wall/fix structure



FOLK-15
Double Door Lock
₹ 575.00

Specification

- Material : Stainless steel
- Finish : Satin stainless steel
- One side key/one side knob
- Suitable for 10/12mm Glass
- Glass preparation/cutout not required
- With gasket to prevent glass from damage
- With three bass computer key
- Suitable for glass to glass



FOLK-16
Single Door Lock
₹ 450.00

Specification

- Material : Stainless steel
- Finish : Satin stainless steel
- One side key/one side knob
- Suitable for 10/12mm Glass
- Glass preparation/cutout not required
- With gasket to prevent glass from damage
- With three bass computer key
- Suitable for glass to wall/fix structure

LOCKS WITHOUT CUTOUT

SS 304 Grade



FOLK-17
Double Door Lock (Only Knob)
₹ 7756165.00

Specification

- Material : Stainless steel
- Finish : Satin stainless steel
- One side key/one side knob
- Suitable for 10/12mm Glass
- Glass preparation/cutout not required
- With gasket to prevent glass from damage
- With three bass computer key
- Suitable for glass to glass



FOLK-18
Single Door Lock (Only Knob)
₹ 645.00

Specification

- Material : Stainless steel
- Finish : Satin stainless steel
- One side key/one side knob
- Suitable for 10/12mm Glass
- Glass preparation/cutout not required
- With gasket to prevent glass from damage
- With three bass computer key
- Suitable for glass to wall/fix structure



FOLK-19
Double Door Lock (Key & Knob)
₹ 1225.00

Specification

- Material : Stainless steel
- Finish : Satin stainless steel
- One side key/one side knob
- Suitable for 10/12mm Glass
- Glass preparation/cutout not required
- With gasket to prevent glass from damage
- With three bass computer key
- Suitable for glass to glass



FOLK-20
Single Door Lock (Key & Knob)
₹ 1090.00

Specification

- Material : Stainless steel
- Finish : Satin stainless steel
- One side key/one side knob
- Suitable for 10/12mm Glass
- Glass preparation/cutout not required
- With gasket to prevent glass from damage
- With three bass computer key
- Suitable for glass to wall/fix structure

DESIGNER LOCKS



FODL-14A+14C
Double Sliding Door Lock With Strike Box
₹ 7750.00



FODL-14A+14C
Single Sliding Door Lock With Strike Box
₹ 6165.00



LOCKS WITHOUT CUTOUT



FODL-03
Door Lock (Key & Knob)
₹ 4680.00

Specification

- Material : Stainless steel 304
- Finish : Mirror
- One side key/one side knob
- Suitable for 10/18mm Tempered Glass
- Glass preparation/cutout not required
- With gasket to prevent glass from damage
- With Four brass computer key
- Brass Cylinder
- Suitable for glass to wall/fix structure

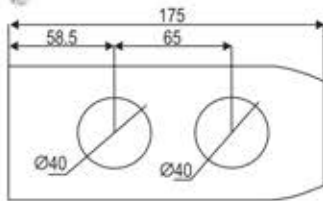

FODL-04
Door Lock (Key & Knob)
₹ 6200.00

Specification

- Material : Stainless steel 304
- Finish : Mirror
- One side key/one side knob
- Suitable for 10/18mm Tempered Glass
- Glass preparation/cutout not required
- With gasket to prevent glass from damage
- With Four brass computer key
- Brass Cylinder
- Suitable for glass to glass

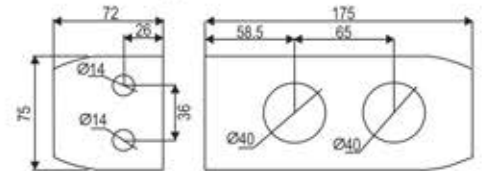

FODL-13A+13C
Door Lock (Key & Knob)
₹ 6200.00

Specification

- Material : Stainless steel 304
- Finish : Mirror
- One side key/one side knob
- Suitable for 10/18mm Tempered Glass
- Glass preparation/cutout not required
- With gasket to prevent glass from damage
- With Four brass computer key
- Brass Cylinder
- Suitable for glass to wall/fix structure

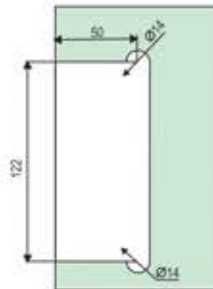

FODL-13A+13B
Door Lock (Key & Knob)
₹ 7200.00

Specification

- Material : Stainless steel 304
- Finish : Mirror
- One side key/one side knob
- Suitable for 10/18mm Tempered Glass
- Glass preparation/cutout not required
- With gasket to prevent glass from damage
- With Four brass computer key
- Brass Cylinder
- Suitable for glass to glass

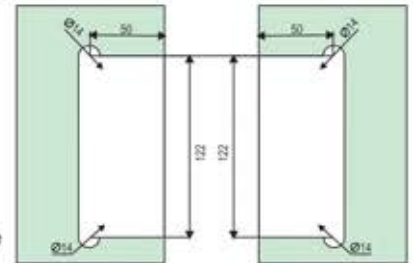

FODL-23
Door Lock (Key & Knob)
₹ 5670.00

Specification

- Material : Zinc Alloy
- Finish : Chrome Plated
- One side key/one side knob
- Suitable for 10/18mm Tempered Glass
- Glass preparation/cutout not required
- With gasket to prevent glass from damage
- With Four brass computer key
- Brass Cylinder
- Suitable for glass to wall/fix structure

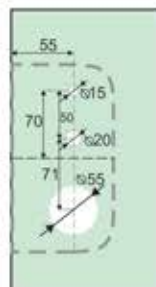

FODL-24
Door Lock (Key & Knob)
₹ 7200.00

Specification

- Material : Zinc Alloy
- Finish : Chrome Plated
- One side key/one side knob
- Suitable for 10/18mm Tempered Glass
- Glass preparation/cutout not required
- With gasket to prevent glass from damage
- With Four brass computer key
- Brass Cylinder
- Suitable for glass to glass

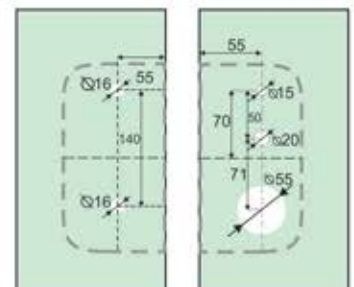

AUTOMATIC SLIDING SENSOR DOOR

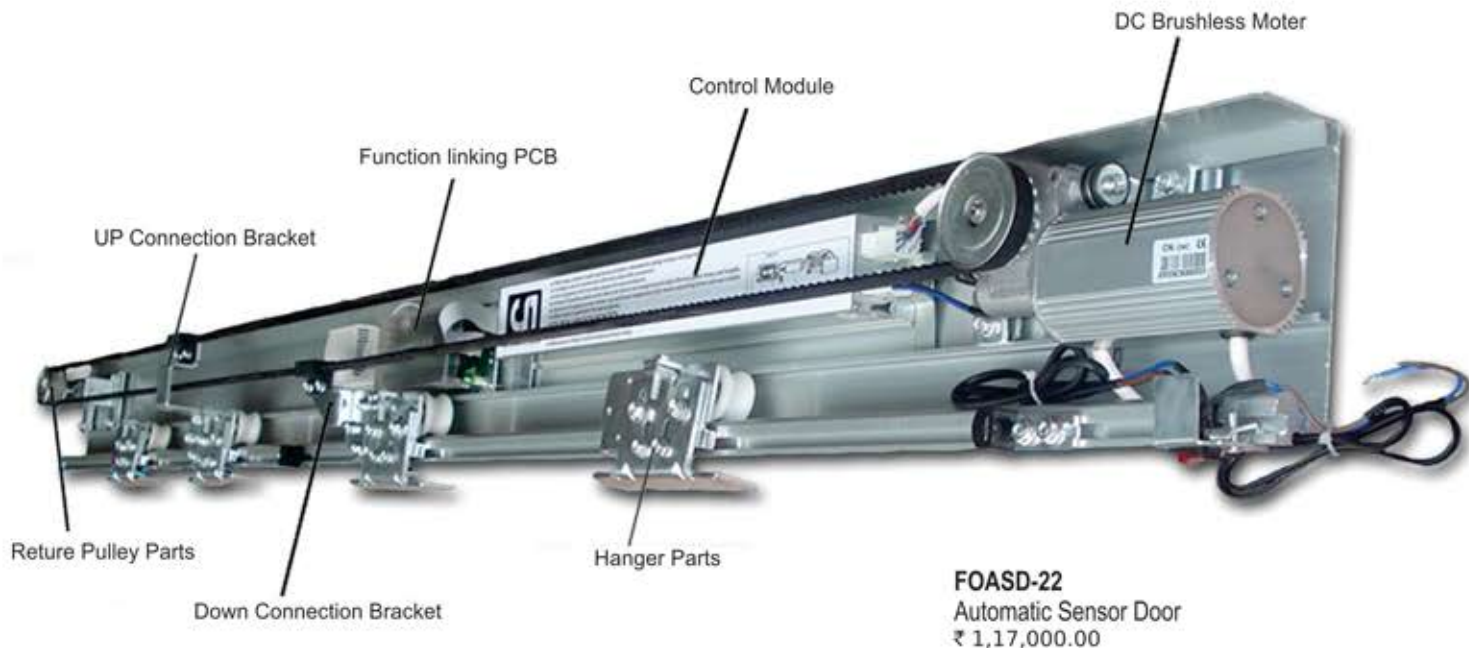

Specification

Door Parameter	
Single Leaf Maximum Opening	1200mm x 2400mm
Bi-parting Door Maximum Opening	2200mm x 2400mm
Maximum Door Weight Single Leaf	75kg to 90kg (Single Door)
Maximum Door Weight Double Leaf	75kg x 2 Door (Bi-parting)

AUTOMATIC DOOR PARAMETER

TYPE	SASD-1
Opening Speed	Adjust Between 250-600mm/Sec.
Closing Speed	Adjust Between 150-300mm/Sec.
Holding Time	1-15 Sec.
Pushing Force	<37N <45N
Power	Ac 200-250V
Voltage	DC 24V-50W
Environment Temperature	-200C - +500C

Features and advantages

- Intelligent control system.
- Drive equipment with low noise.
- Advanced brushless motor and worm wheel reducer are integrated.
- Special self-locking function without any addition components.
- With different triggered opening modes.
- Double door interlock function.
- Optional power supply backup to ensure the normal operation.
- When door is closed, it shall be locked and kept closed.
- Apply to doors for garage, usage of anti-radiation for hospitals, warehouses, science and technology factories, barrier-free space, commercial building, shopping mall, etc.
- Easy installation & low maintenance.
- Track size : 4200mm/6400mm.

DOOR HANDLES

* Refer to original product for cutout and hole to hole distance
C to C : Centre to Centre Hole

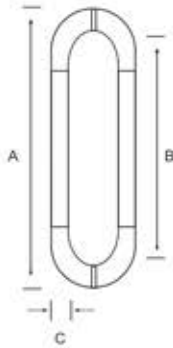

FODH-11

Specification

- Finish : Satin + Polish stainless steel / Full Satin
- Material : Stainless steel
- For back to back installation
- With gasket to prevent glass from damage
- With grub screw to give neat look
- All sizes in mm

Overall Length	C to C Hole	Diameter	₹
175	150	25	414.00
225	200	25	460.00
330	305	25	580.00
480	455	25	1156.00
480	450	32	1350.00

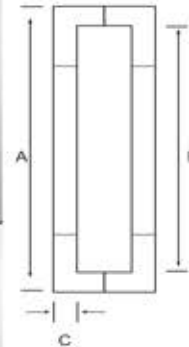
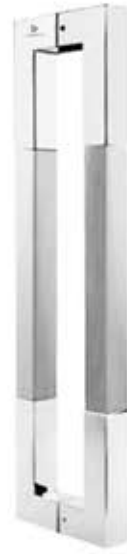

FODH-44

Specification

- Finish : Satin + Polish stainless steel
- Material : Stainless steel
- For back to back installation
- With gasket to prevent glass from damage
- With grub screw to give neat look
- All sizes in mm

Overall Length	C to C Hole	Diameter	₹
327	302	25x25	1415.00
480	450	30x30	2190.00
600	570	30x30	2835.00

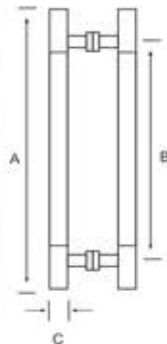

FODH-55

Specification

- Finish : Satin + Polish stainless steel / Full Satin
- Material : Stainless steel
- For back to back installation
- With gasket to prevent glass from damage
- With grub screw to give neat look
- All sizes in mm

Overall Length	C to C Hole	Diameter	₹
250	200	25	513.00
300	250	25	567.00
350	300	25	615.00
457	302	32	975.00
600	450	38	1350.00
800	600	38	1800.00
900	600	38	1935.00
900	700	38	1935.00
1200	900	38	2340.00
1500	1200	38	3240.00

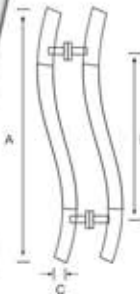

FODH-77

Specification

- Finish : Satin + Polish stainless steel
- Material : Stainless steel
- For back to back installation
- With gasket to prevent glass from damage
- With grub screw to give neat look
- All sizes in mm

Overall Length	C to C Hole	Diameter	₹
350	250	25	990.00
457	302	32	1170.00
600	450	32	1575.00



FODH-55E (CP+Matt)

Overall Length	C to C Hole	Diameter	₹
457	302	32	900.00

FODH-55G (Gold)

Overall Length	C to C Hole	Diameter	₹
457	302	32	1800.00

FODH-55RG (Rose Gold)

Overall Length	C to C Hole	Diameter	₹
457	302	32	1800.00

FODH-55B (Black Matt)

Overall Length	C to C Hole	Diameter	₹
457	302	32	1575.00

DOOR HANDLES

* Refer to original product for cutout and hole to hole distance
C to C : Centre to Centre Hole

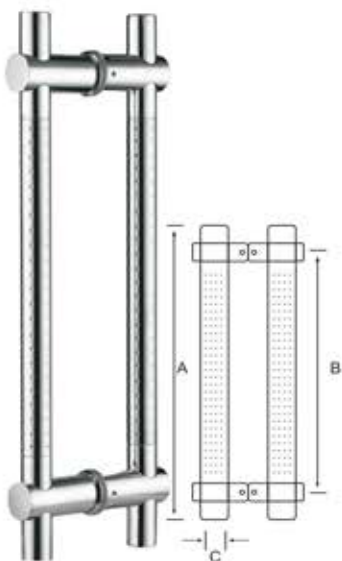

FODH-55 (Adjustable)

Specification

- Finish : Satin + Polish stainless steel
- Material : Stainless steel
- For back to back installation
- With gasket to prevent glass from damage
- With grub screw to give neat look
- All sizes in mm

Overall Length	C to C Hole	Diameter	₹
350	200	25	1030.00
457	302	32	1170.00
600	450	32	1440.00
900	600	32	1800.00
1200	900	32	2200.00



FODH-WSS-301

Specification

- Finish : Wood/ Polish Stainless Steel (TW/PSS)
- Material : Stainless steel/ Teak Wood
- For back to back installation
- With gasket to prevent glass from damage
- With grub screw to give neat look
- All sizes in mm

Overall Length	C to C Hole	Diameter	₹
450	302	25x45	1755.00
600	455	25x45	2200.00

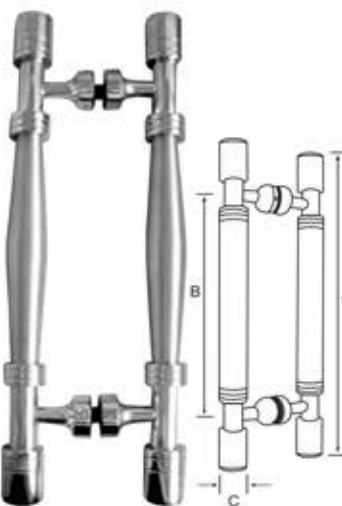

FODH-66

Specification

- Finish : Satin + Polish stainless steel
- Material : Stainless steel
- For back to back installation
- With gasket to prevent glass from damage
- With grub screw to give neat look
- All sizes in mm

Overall Length	C to C Hole	Diameter	₹
457	302	38	1935.00



FODH-WSS-303

Specification

- Finish : Wood/ Polish Stainless Steel (TW/PSS)
- Material : Stainless steel/ Teak Wood
- For back to back installation
- With gasket to prevent glass from damage
- With grub screw to give neat look
- All sizes in mm

Overall Length	C to C Hole	Diameter	₹
500	302	38	2520.00
850	455	38	3420.00

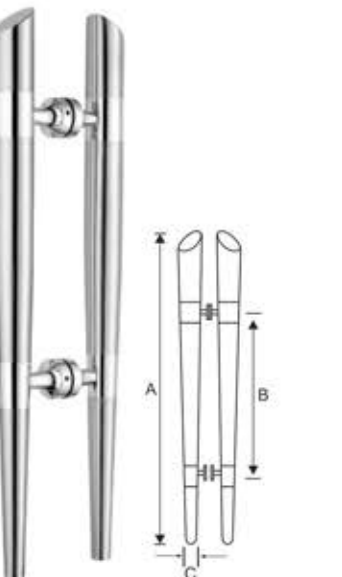

FODH-99

Specification

- Finish : Satin + Polish stainless steel / Full Satin
- Material : Stainless steel
- For back to back installation
- With gasket to prevent glass from damage
- With grub screw to give neat look
- All sizes in mm

Overall Length	C to C Hole	Diameter	₹
457	302	38	1350.00
600	450	38	1710.00



FODH-WSS-302

Specification

- Finish : Wood/ Polish Stainless Steel (TW/PSS)
- Material : Stainless steel/ Teak Wood
- For back to back installation
- With gasket to prevent glass from damage
- With grub screw to give neat look
- All sizes in mm

Overall Length	C to C Hole	Diameter	₹
450	302	38x25	1755.00
600	455	38x25	2200.00

DOOR HANDLES

* Refer to original product for cutout and hole to hole distance
C to C : Centre to Centre Hole

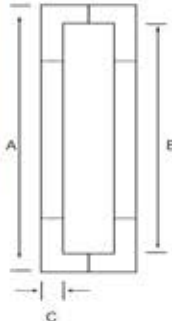

FODH-WSS-304

Specification

- Finish : Wood/ Polish Stainless Steel (TW/PSS)
- Material : Stainless steel/ Teak Wood
- For back to back installation
- With gasket to prevent glass from damage
- With grub screw to give neat look
- All sizes in mm

Overall Length	C to C Hole	Diameter	₹
327	302	25x25	1440.00
480	450	30x30	2070.00
600	570	30x30	2700.00

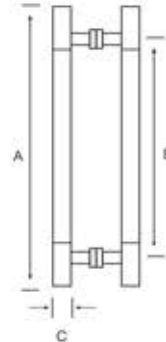

FODH-309 (Crystal)

Specification

- Finish : Satin + Polish stainless steel / Full Satin
- Material : Stainless steel / Crystal
- For back to back installation
- With gasket to prevent glass from damage
- With grub screw to give neat look
- All sizes in mm

Overall Length	C to C Hole	Diameter	₹
457	302	38	1800.00
600	450	38	2200.00

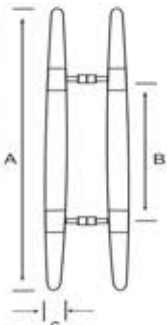

FODH-WSS-308

Specification

- Finish : Wood/ Polish Stainless Steel (TW/PSS)
- Material : Stainless steel/ Teak Wood
- For back to back installation
- With gasket to prevent glass from damage
- With grub screw to give neat look
- All sizes in mm

Overall Length	C to C Hole	Diameter	₹
450	302	32	1710.00

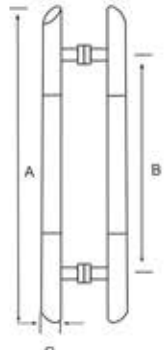

FODH-310 (Crystal)

Specification

- Finish : Satin + Polish stainless steel
- Material : Stainless steel / Crystal
- For back to back installation
- With gasket to prevent glass from damage
- With grub screw to give neat look
- All sizes in mm

Overall Length	C to C Hole	Diameter	₹
457	302	38	1800.00
600	450	38	2200.00



DOOR HANDLES

* Refer to original product for cutout and hole to hole distance
C to C : Centre to Centre Hole

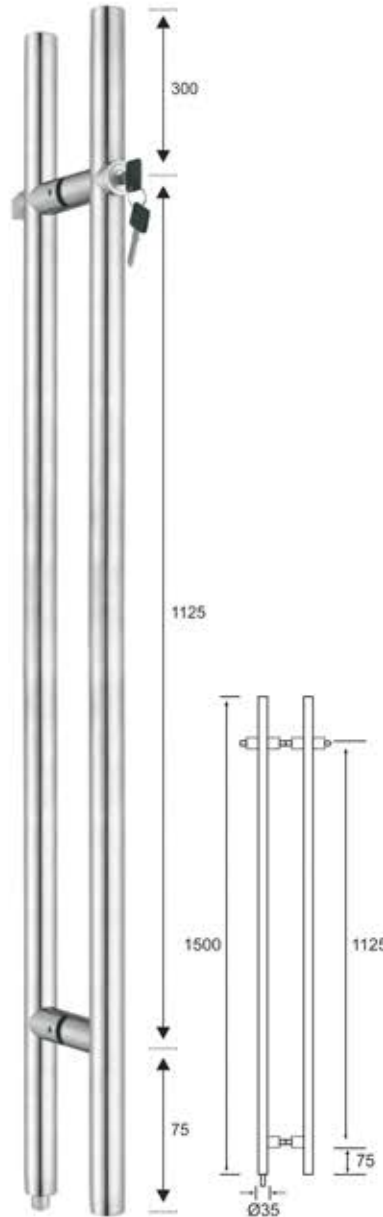

FODHL-55
Size : 35x1500mm
₹ 10800.00
Specification
• Operation One side key/one side Knob
• Finish : Satin stainless steel (SSS)
• Material : Stainless steel 304 grade
• For back to back installation
• With gasket to prevent glass from damage
• With grub screw to give neat look
• All sizes in mm

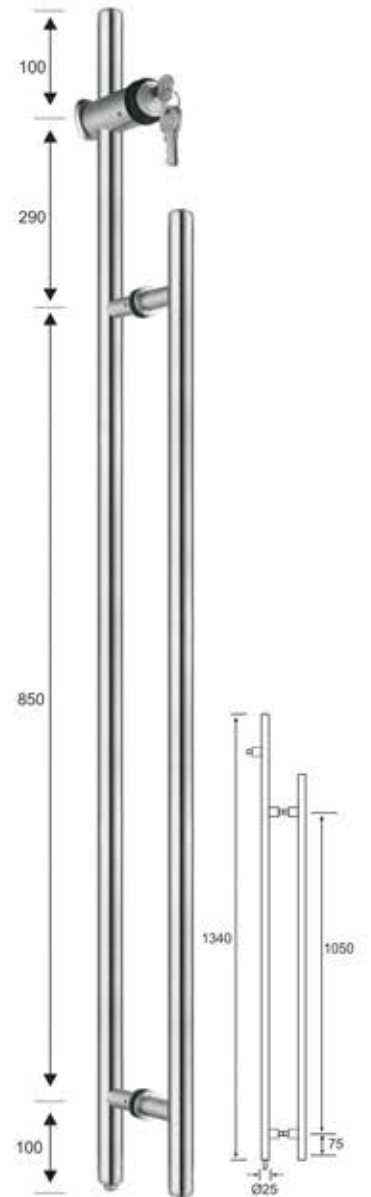

FODHL-55
Size : 25x1340mm
₹ 9900.00
Specification
• Operation One side key/one side Knob
• Finish : Satin stainless steel (SSS)
• Material : Stainless steel 304 grade
• For back to back installation
• With gasket to prevent glass from damage
• With grub screw to give neat look
• All sizes in mm

**Shower Handles
(SS 304)**



FODH-TB-01
Sizes :
19x152x457CC (₹ 835.00)
25x152x457CC (₹ 1095.00)



FODH-TB-02
Sizes : 15/30x152x457CC
₹ 1150.00

SHELF SUPPORT BUTTONS & BRACKETS



FOSSB-1
Material : Zinc



FOSSB-2
Material : SS



FOSSB-3
Material : SS (H)
L Button



FOSSB-4
Material : Brass / Zinc
Single



FOSSB-5
Material : Brass / Aluminum
Shoe



FOSSB-6
Material : Brass / Zinc
Round



FOSSB-7
Material : Zinc
Pan



FOSSB-8
Material : Brass / Zinc
Double



FOSSB-9
Material : Brass / Aluminum
Double Vacuum (H)



FOSSB-10
Material : Brass / Zinc
Double (H)



FOSSB-11
Material : Brass / Zinc
Pyramid



FOSSB-12
Material : Brass / Zinc
Rectangle



FOSSB-13
Material : Brass / Zinc
Square Bat



FOSSB-14
Material : Unbreakable
Acrylic Button



FOSSB-15
Material : Unbreakable
Acrylic Button

SHELF HOLDING BRACKETS



FOSHB-1
Material : SS
Finish : Chrome / Matt
D Bracket



FOSHB-2
Material : Brass
Finish : Chrome / Matt
D Bracket



FOSHB-3
Material : Brass
Finish : Chrome / Matt
Folding Bracket



FOSHB-4
Material : SS
Finish : Chrome / Matt
Folding Bracket



FOSHB-5
Material : Zinc / Brass
Finish : Chrome / Matt
Rectangle Bracket



FOSHB-6
Material : PVC
Finish : White / Clear
Corner Bracket

SHELF HOLDING 'F' BRACKETS



FOFB-1
Material : Cast Iron
Finish : Chrome / Matt
F Bracket



FOFB-2
Material : SS
Finish : Chrome / Matt
Sheet (Patti) Bracket



FOFB-3
Material : Powder Coated Iron
Finish : Silver / Brown/ Sand Black
Square P/C Bracket



FOFB-4
Material : SS
Finish : Chrome / Matt
Square Bracket



FOFB-5
Material : Brass
Finish : Chrome / Matt
F Bracket



FOFB-7 (Adjustable)
Material : SS
Finish : Chrome / Matt
Square Bracket



FOFB-8
Material : SS
Finish : Chrome / Matt
A Bracket



FOFB-9
Material : SS
Finish : Chrome / Matt
SL Sheet (Patti) Bracket



FOFB-10
Material : Brass + SS
Finish : Chrome / Matt
SL Rod Bracket



FOFB-11
Material : Powder Coated Iron
Finish : Brown
Folding Bracket

SHELF HOLDING CHANNEL & BRACKET



Bracket
Material : M/S (CP Finish)



Bracket
Material : Steel
Finish : Matt / Chrome



Channel 6 / 7 Ft.
Material : Steel / Iron
Finish : Matt / Chrome

MIRROR ACCESSORIES



FOMC-1
Material : SS (304) / Brass
Finish : Chrome / Matt
Round Plain



FOMC-2
Material : SS (304) / Brass
Finish : Chrome / Matt
Pyramid



FOMC-3
Material : SS (304) / Brass
Finish : Chrome / Matt
Swastika



FOMC-4
Material : Brass
Finish : Chrome
Crystal



FOMC-5
Material : Brass
Finish : Chrome / Matt
Doom

MIRROR BRACKETS



FOMB-1
Material : Brass
Finish : Chrome + Matt



FOMB-2
Material : Brass
Finish : Chrome + Matt
Cut



FOMB-3
Material : Brass
Finish : Chrome + Matt
Full



FOMB-4
Material : Brass
Finish : Chrome
Crystal Cut



FOMB-5
Material : Brass
Finish : Chrome
Crystal Full



FOMB-6
Material : Brass
Finish : Chrome
Square Crystal Cut



FOMB-7
Material : Brass
Finish : Chrome
Square Crystal Full

SPACERS



FOSP-1
Material : SS
Finish : Matt
Plain



FOSP-2 (Hollow Spacer)
Available in all sizes



FOSP-3
Material : SS/Aluminium
Finish : Chrome
Crystal



FOSP-4
Material : SS
Finish : Chrome
Male



FOSP-5
Material : SS
Finish : Chrome
Doom Nut



FOSP-6
Material : SS
Finish : Chrome + Matt
Washer



FOSP-7
Material : SS
Finish : Chrome + Matt
Male Female



GLASS PIVOTS



FOGP-1
Material : Brass
Finish : Chrome + Matt
Pivot



FOGP-2
Material : SS
Finish : Chrome + Matt
Pivot



FOGP-3
Material : Iron
Finish : Chrome + Matt
Pivot



FOGP-4
Material : SS Brass
Finish : Chrome + Matt
Floor Pivot



FOGP-5
Material : Brass
Brass Centre Pivot

BRACKET SHELF HOLDERS



FOBSH-1
Double Shelf Holder
(10-12mm)



FOBSH-2
Single Shelf Holder
(10-12mm)



FOBSH-3
F-Type Shelf Holder
(6-12mm)



FOBSH-4
Double Shelf Holder
(8-10mm)



FOBSH-5
Single Shelf Holder
(8-10mm)

SHELF BARREL BUTTON



FOBSH-6
Double Shelf Barrel Button



FOBSH-6
Single Shelf Barrel Button

GLASS HINGES (WITH HOLE) (For 5mm-10mm Glass)



FOGH-1
Material : SS (304)
Wall to Glass Hinge



FOGH-2
Material : SS (304)
Glass to Glass Hinge



FOGH-3
Material : Zinc
Wall to Glass Hinge
Heavy Duty



FOGH-4
Material : Zinc
Wall to Glass Hinge
Jumbo



FOGH-5
Material : Brass
Wall to Glass Hinge
Square Deluxe



FOGH-6
Material : Brass
Wall to Glass Hinge
Round Deluxe



FOGH-7
Material : Brass
Wall to Glass Hinge
Royal

GLASS HINGES (WITHOUT HOLE) (For 5mm-10mm Glass)



FOGH-8
Material : Brass
Wall to Glass Hinge
Deluxe



FOGH-9
Material : Brass / Zinc
Wall to Glass Hinge
Neelam



FOGH-10
Material : Brass / Zinc
Wall to Glass Hinge
Cobra



FOGH-11
Material : Zinc
Wall to Glass Hinge
Side Hinge



FOGH-12
Material : Zinc
Wall to Glass Hinge
Square



FOGH-13
Material : Brass
Wall to Glass Hinge
Corner



FOGH-14
Material : Brass
Glass to Glass Hinge



Round Cutter

GLASS HOLDERS



Two Way Glass Holder



Three Way Glass Holder



Four Way Glass Holder



GLASS VACCUMS



GLASS RUNNERS



FOGR-1 (Plain)
Material : Iron
Finish : Chrome



FOGR-2 (Cut)
Material : Iron
Finish : Chrome



FOGR-5
Material : SS
Finish : Chrome / Matt



FOGR-3
Material : Iron (Powder Coted)
Finish : Chrome / Teak / Brown



FOGR-4
Material : Iron (Powder Coted)
Finish : Chrome / Teak / Brown

MIRROR & WOODEN SCREWS



FOMS-1



FOMS-2



Brass Machine Screw



Wooden Screws

OTHER HARDWARE PRODUCTS



FOOH-2
Glass Lock



FOOH-7
Material : Brass / SS
'L' Hinges



FOOH-8
Material : Brass / SS
'W' Hinges

PUSH CATCHER



FOPC-1
Material : Brass
Finish : Chrome + Matt
Push



FOPC-2
Material : Pvc
Finish : Brown / Black
Push



FOPC-3
Material : Pvc (Heavy)
Finish : White
Push



FOGL-1C
Glass Lifter with One Cups



FOGL-2C
Glass Lifter with Two Cups



FOGL-3C
Glass Lifter with Three Cups

GLASS LIFTERS

GLASS CUTTER



FOGC-XY-3



FOGC-100



FOGC-999



Glass Bit



FOGC-YGD-4



FOGC-90



FOGC-110



FOGC-111
with Double Head



GLASS RAILING ACCESSORIES

SPIGOT



FORA-1
Spigot
₹ 4300.00 (Matt)
₹ 4590.00 (CP)



FORA-2
Spigot
₹ 1980.00 (Matt)
₹ 2070.00 (CP)



FORA-2A
Spigot
₹ 1150.00 (Matt) 125mm
₹ 1285.00 (Matt) 150mm
₹ 1095.00 (CP) 125mm
₹ 1350.00 (CP) 150mm



FORA-2B
Spigot
₹ 920.00 (Matt) 100mm
₹ 965.00 (CP) 100mm



FORA-3
Spigot
₹ 1980.00 (Matt)
₹ 2070.00 (CP)



FORA-4
Spigot
₹ 1980.00 (Matt)
₹ 2070.00 (CP)



FORA-4A
Spigot
₹ 918.00 (Matt)
₹ 963.00 (CP)



FORA-5
Spigot
₹ 2205.00 (Matt)
₹ 2340.00 (Matt)



FORA-6
Spigot
₹ 2205.00 (Matt)
₹ 2340.00 (CP)



FORA-7
Spigot
₹ 4500.00 (Matt)
₹ 5000.00 (CP)



FORA-8
Spigot
₹ 3465.00 (Matt)
₹ 3735.00 (CP)

GLASS RAILING ACCESSORIES



FORA-9
Spigot Mini
₹ 800.00 (Matt)
₹ 840.00 (CP)



FORA-10
Spigot Mini
₹ 800.00 (Matt)
₹ 840.00 (CP)



FORA-11
Wall to Handrail
₹ 465.00



FORA-12
Glass to Handrail
₹ 575.00



FORA-13
Glass to Handrail
₹ 1125.00



FORA-14
(Wall to Handrail)
Adjustable
₹ 1035.00



FORA-15
Glass to Handrail
₹ 1080.00



FORA-16 (Dolphin)
Glass to Handrail
₹ 1125.00



FORA-17 (Flat)
U Shape Railing Connector
₹ 315.00



FORA-18 (Curve)
U Shape Railing Connector
₹ 315.00

GLASS RAILING ACCESSORIES

STUDS



FORA-19
Railing Stud 45mm
₹ 645.00
w/o plate ₹ 715.00



FORA-20
Railing Stud 25mm
₹ 666.00
w/o plate ₹ 540.00



FORA-21
Glass Adjustable Stud
₹ 1095.00

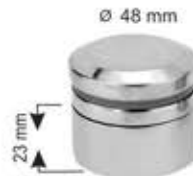

FORA-22
Glass Adjustable Stud
₹ 900.00



FORA-23
Railing Twin Stud
₹ 1305.00



FORA-24
Square Railing Stud
(Dia 40x40mm)
₹ 1305.00



FORA-25
Single Slotted Square Pipe
₹ 645.00 (40x40)
₹ 706.00 (40x60)



FORA-26
Single Slotted Round Pipe
₹ 645.00 per ft.



FORA-27
Slotted Pipe Jointer 180°
₹ 1260.00



FORA-28
Round Pipe Jointer 90°
₹ 1485.00



FORA-29
Round Pipe Jointer L-Type 90°
₹ 1665.00



FORA-30
Straight Jointer
₹ 1260.00



FORA-31
Wall to Slotted Pipe Jointer
₹ 1135.00



FORA-32
Slotted Pipe End Cap
₹ 810.00



FORA-33
Sq. Slotted Pipe Jointer 180°
₹ 1260.00



FORA-34
Sq. Pipe Jointer 90°
₹ 1485.00



FORA-35
Sq. Pipe Jointer L-Type 90°
₹ 1665.00



FORA-36
Straight Jointer
₹ 1260.00



FORA-37
Wall to Slotted Pipe Jointer
₹ 1035.00



FORA-38
Slotted Pipe End Cap
₹ 810.00

GLAZING PROFILES



FOGL-UPR-11
'U' Channel
Finish: CP
₹ 2300.00 (25x15x25) 11.25 ft.
₹ 2835.00 (35x15x35) 11.25 ft.



FOGL-22
Wall Connecting Profile for Fix Glass
Finish: Sparkle & Anodised
₹ 2575.00 (3 mtr.)
₹ 3330.00 (4 mtr.)



FOGL-33
Wall Connecting Profile for Fix Glass
Finish: Sparkle & Anodised
₹ on Request



FOGL-44
₹ on Request
Aluminium Slotted Pipe, Pillar with Cover Plate
Finish: Anodised, Antique & Wooden



FOGL-55
₹ on Request

WASHROOM PARTITIONS



Holder



Handle



Indicating Lock



Connection Angle



Hook



Hinge

Material : SS 304

- 1 Set Contain
- Holder (2 Pcs)
- Hinge (1 Pair)
- Indicating Lock (1 Pcs)
- Handle (1 Pair)
- connecting Angle (12 Pcs)
- Hook (1 Pcs)



Holder



Connection Angle



Hook



Hinge



Handle



Indicating Lock

Material : Nylon

- 1 Set Contain
- Holder (2 Pcs)
- Hinge (1 Pair)
- Indicating Lock (1 Pcs)
- Handle (1 Pair)
- connecting Angle (12 Pcs)
- Hook (1 Pcs)



DOUBLE SIDED STRUCTURAL GLAZING TAPE

ADHESIVE	Acrylic
ADHESIVE CARRIER	Acrylic Foam
THICKNESS	1.2mm & 2.0 mm
TAPE COLOR	Grey
LINER	Red PE Film
PACKING	100 rolls per cartoon

* Customized size available according to specific order.



Glazing Double Side Tape

- * Durable, high performance two-sided pressure sensitive acrylic foam tapes.
- * A high strength, clear, UV resistant double-sided film.
- * Has high adhesion and shear strength.
- * Heat and solvent resistant.
- * A good general purpose, permanent glazing tape.

Applications:

- * Bonding glass to metal frames (aluminium panel) in curtain wall systems and commercial windows
- * Attachment of stiffeners and perimeter clips to architectural panels
- * Exterior building cladding

Special Feature

- Easy to assemble, no drilling, riveting, welding or screw fastening.
- Excellent seal against water, moisture and dust.
- Quick and easy to apply, saves time, labour costs and greater bonding strength.
- Ideal for bonding to a variety of substrates like most metals, glass, plastics, composites and painted surface.



Colour	Thickness mm	Tensile Strength gf/cm ²	Elongation %	Adhesion Strength 180 E gf/25mm)	Shear Strength gf/cm ²	Density of Foam g/cm ³	Holding Power Hr
Grey	1.2	>=6500	900	>=4500	Before 20minutes >4000 After 24hours >6500	800	>24
Grey	2	>=5500	900	>=4500	Before 20minutes >3500 After 24hours >5500	800	>24

ADHESIVE



UV Adhesive
₹ 2500.00



UV Adhesive
₹ 375.00



UV Light
* Price on Request

SILICONE SEALANT

EXCELLENT SEAL

EXCELLENT BONDING

EXCELLENT WEATHERABILITY

* Price on Request

Neutral Weatherproof Silicone Sealant

Characteristics:

- Highly elastic and excellent unpermed adhesion to most building excellent materials.
- Long use life, with high resistance to ultraviolet radiation, rainfall, heat and humidity.
- Excellent resistance against temperature extremes, remains flexible within temperature range of -40°C to +100°C
- One part with outstanding weatherability and resistance to again

Major Uses:

- Weatherproof sealing of glass curtain wall.
- Weatherproofing sealing of various metals, aluminum curtain walls and building facades.
- Joint seal of other concrete or plastic constructions.
- A variety of other building and industria uses.

Storage Shelf Life:

FITONN 789 weatherproof silicone sealant should be stored in cool and dry places over the temperature from 0°C to 27°C, under which the shelf life is 12 months from the date of production

Limitations:

- Not suitable for confined or non-ventilated places as weatherproof sealant requires atmospheric moisture to cure.
- Not suitable for wet/frosty surfaces.
- Do not apply with the surfaces that needs to be painted or have continuous contact with water
- Do not apply with the material having surface temperature not between 5°C to 50°C.



General Purpose Silicone Sealant

Characteristics:

- Easy to use, one-part sealant cured quickly, good weather ability.
- One-componet acetic cured, no mixing required.
- Adhesive to metals, glass, glazed, plastic, paint coated surfaces and many building materials.
- Excellent UV, ozone and chemical resistance, unattached by sunlight, rain, snow and temperature extremes

Major Uses:

- For joint filling and window sealing
- For sealing doors glass-related buildings
- For non-oily wood, coated surfaces Aluminum alloy and ceramic tiles etc.

Storage Shelf Life:

FITONN GP should be stored in cool and dry places over the temperature from 0°C to 27°C, under which the shelf life is 12 months from the date of production

Limitations:

- Do not use for curtain wall structural glazing.
- Not suitable for confined or non-ventilated places as it requires atmospheric moisture to cure.
- Not suitable for wet/frosty surfaces.
- Do not apply with the surfaces that needs to be painted or have continuous contact with water
- Do not apply with the material having surface temperature not between 5°C to 50°C.

SILICON GUN



Silicon Gun
₹ 207.00



Silicon Gun (Heavy)
₹ 325.00



FITONN[®]
ARCHITECTURAL HARDWARE
E-mail : fitonn@gmail.com

